



直綠春實業股份有限公司

總公司/台中縣大里市國中路483巷11號

T 04-2406-5488 F 04-2406-5051

TAIWAN OFFICE:

NO 11,LANE 483,KUO CHUNG ROAD.TA LI

TAICHUNG,TAIWAN R.O.C.

Tel 886-4-2406-5488

Fax 886-4-2406-5051

e-mail:terryoni@gmail.com

e-mail:fggreen@ms77.hinet.net

www.fggreen.com.tw

品質 · 服務 · 誠信



直綠春實業股份有限公司
FERTILE GREEN INDUSTRIAL CO., LTD.



Mini-fix and connector series

Company Introduction

We are a professional manufacturer specializing in furniture hardware parts and accessories since 1989.
OEM & ODM orders are welcome !!

Anderson Lin



Index



- 1-9 Mini-Fix And Connector Series
- 10-22 Hinge
- 23-29 Slide
- 30-34 Castor And Sliding Door Fitting
- 35-39 Catch
- 40-42 Other Plastics Fittings
- 43-45 Board Support Series
- 46-49 Hardware for TV & BED
- 50-52 Adjustable Leg & Table Leg
- 53-57 Handle & knob





Bolt

Bolt

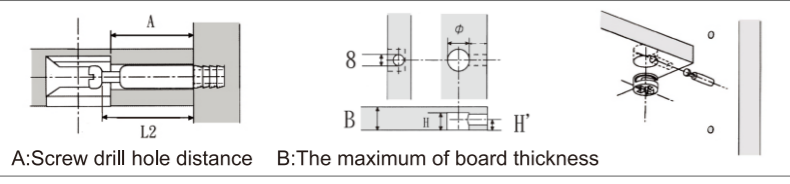

0050

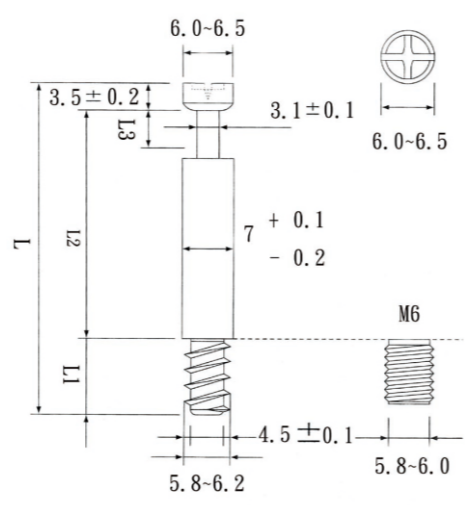
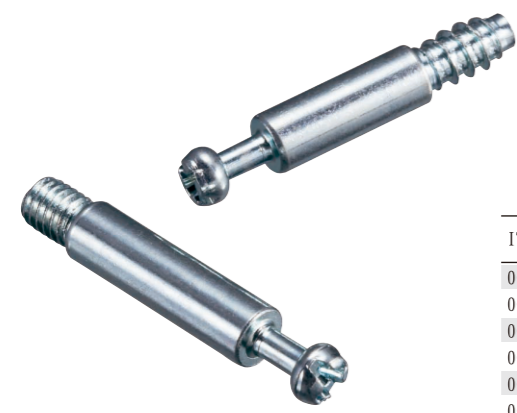

ITEM NO.	L2 (mm)	L1 (mm)	L (mm)	L3 (mm)	A (mm)	Weight (g)	Packing (pcs)
0050M-20-0	20.5±0.2	M6X8	31.5	5.5±0.2	24	6.8	1000
0050M-24-0	24.5±0.2	M6X8	35.5	5.5±0.2	28	8.0	1000
0050M-24-1	24.5±0.2	M6X12	40.0	5.5±0.2	28	8.6	1000
0050M-30-0	30.5±0.2	M6X8	41.5	5.5±0.2	34	9.6	1000
0050T-20-0	20.5±0.2	T. SX12	36.0	5.5±0.2	24	7.2	1000
0050T-20-1	20.5±0.2	T. SX8.5	32.5	5.5±0.2	24	6.8	1000
0050T-20-2	20.5±0.2	T. SX10	35.0	5.5±0.2	24	7.0	1000
0050T-20-3	20.5±0.2	T. SX15	39.0	5.5±0.2	24	7.4	1000
0050T-24-0	24.5±0.2	T. SX12	40.0	5.5±0.2	28	8.8	1000
0050T-30-0	30.5±0.2	T. SX12	46.0	5.5±0.2	34	10.0	1000

A: Screw drill hole distance

0060

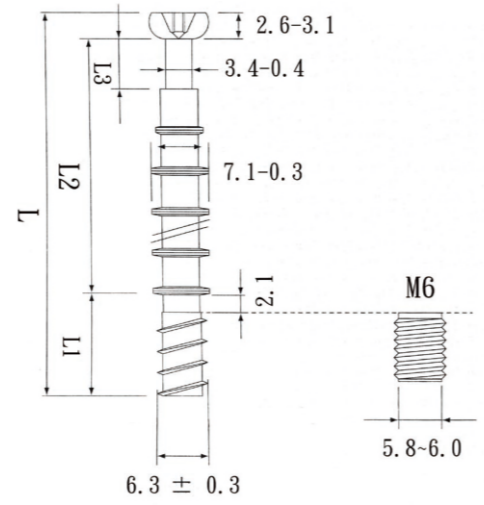
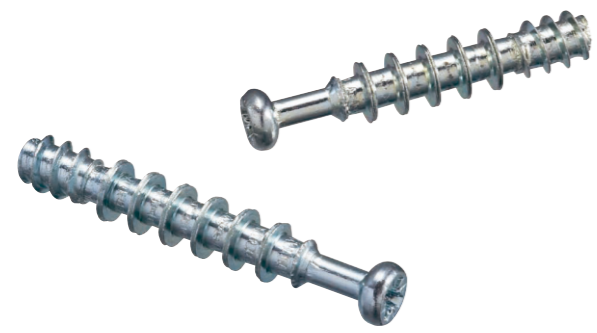

ITEM NO.	L2 (mm)	L1 (mm)	L (mm)	L3 (mm)	A (mm)	Weight (g)	Packing (pcs)
0060T-1	20.3±0.2	T. SX8.9	34	6±0.2	24	4.4	1000
0060T-2	24.3±0.2	T. SX8.9	38	6±0.2	28	5.0	1000
0060T-3	30.3±0.2	T. SX8.9	44	6±0.2	34	5.4	1000
0060M-1	20.3±0.2	M6X8	31	6±0.2	24	4.0	1000
0060M-2	24.3±0.2	M6X8	35	6±0.2	28	4.4	1000
0060M-3	30.3±0.2	M6X8	41	6±0.2	34	4.8	1000

0061

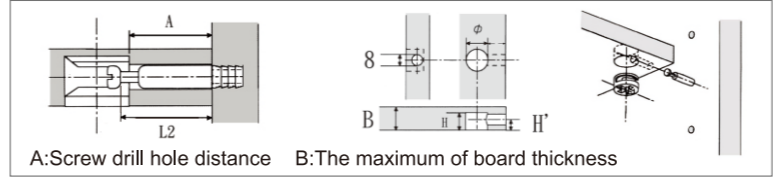

0061

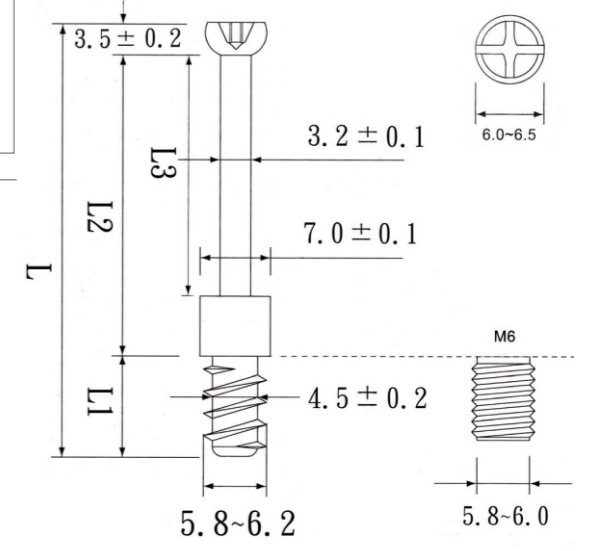

ITEM NO.	L2 (mm)	L1 (mm)	L (mm)	L3 (mm)	A (mm)	Weight (g)	Packing (pcs)
0061T-1	20.3±0.2	T. SX11	34	14±0.2	24	6.0	1000
0061T-2	24.3±0.2	T. SX11	38	18±0.2	28	6.8	1000
0061T-3	30.3±0.2	T. SX11	44	24±0.2	34	7.0	1000
0061M-1	20.3±0.2	M6X8	31	14±0.2	24	4.0	1000
0061M-2	24.3±0.2	M6X8	35	18±0.2	28	4.6	1000
0061M-3	30.3±0.2	M6X8	44	24±0.2	34	5.0	1000

0062

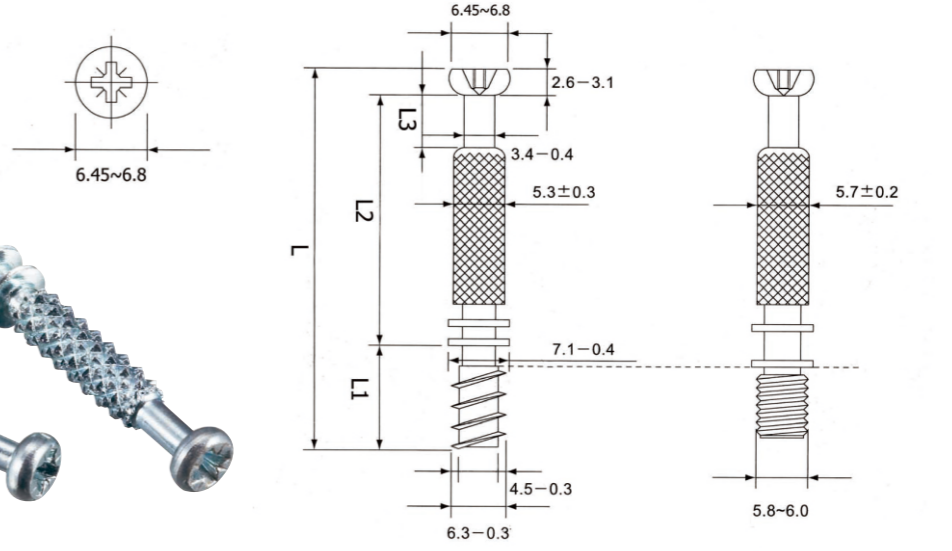
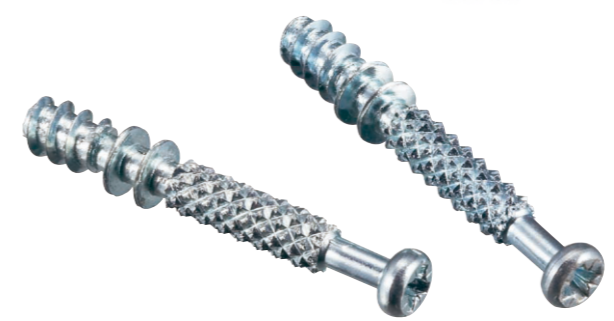

ITEM NO.	L2 (mm)	L1 (mm)	L (mm)	L3 (mm)	A (mm)	Weight (g)	Packing (pcs)
0062T-1	20.3±0.2	T. SX11	34	6±0.2	24	4.4	1000
0062T-2	24.3±0.2	T. SX11	38	6±0.2	28	5.0	1000
0062T-3	30.3±0.2	T. SX11	44	6±0.2	34	5.4	1000
0062M-1	20.3±0.2	M6X8	31	6±0.2	24	4.0	1000
0062M-2	24.3±0.2	M6X8	35	6±0.2	28	4.4	1000
0062M-3	30.3±0.2	M6X8	41	6±0.2	34	4.8	1000



Bolt

Cam/Nut

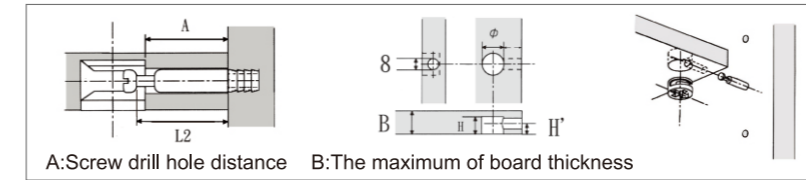
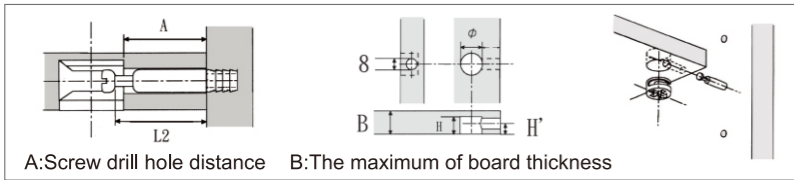

0063

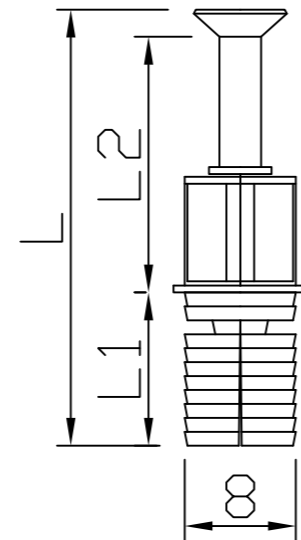

ITEM NO.	L2 (mm)	L1 (mm)	L (mm)	A (mm)	Weight (g)	Packing (pcs)
0063	24	11	31.5	24	3.25	1000

0064

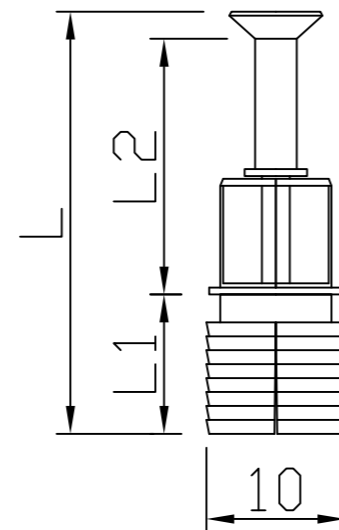

ITEM NO.	L2 (mm)	L1 (mm)	L (mm)	A (mm)	Weight (g)	Packing (pcs)
0064	24	11	32.5	24	3.4	1000

Cam

0050C-12



0050C-14



0051C-12



0051C-10



0052C-12



0052C-14



0052C-16



0052C-19



0070



0053C-12

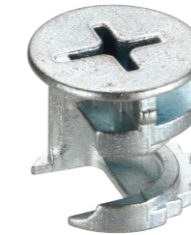

0053C-12



B: The maximum of board thickness

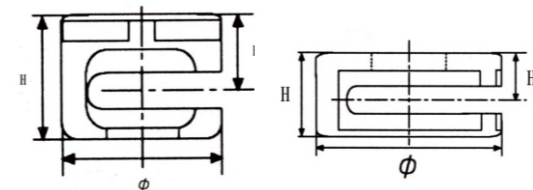

ITEM NO.	H (mm)	Ø (mm)	Weight (g)	B (mm)	H' (mm)	Packing (pcs)
0050C-12	12.5	15	6	16	7.5	1000
0050C-14	14	15	7	19	9.5	1000
0051C-12	12	12	4	15	7.5	1000
0051C-10	10.5	12	3.4	13	6.5	1000
0052C-12	12.5	15	5.5	16	7.5	1000
0052C-14	14	15	7	19	9.5	1000
0052C-16	16	15	6.6	23	11.5	1000
0052C-19	19	15	9.6	29	14.5	1000
0053C-12	12	15	4.25	15	7.5	1000
0053C-12	12	15	4.25	15	7.5	1000
0070C-25	12	25	7.5	16	6.5	1000

Nut

0050PN01

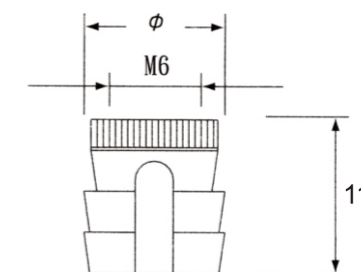

0050PN02



ITEM NO.	Ø (mm)	Packing (pcs)
0050PN01	10	1000
0050PN02	8	1000



Cap/Knock-Down Connector series

Cap
0050PE

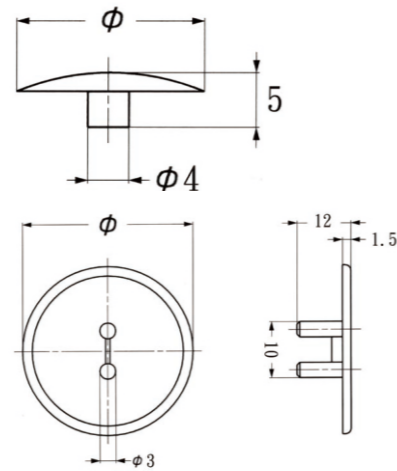

0070PE



ITEM NO.	∅ (mm)	Packing (pcs)
050PE	17	1000
070PE	27	1000

FG0040

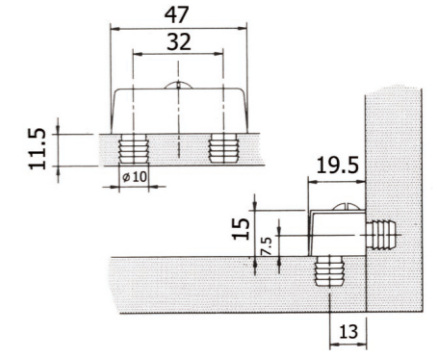

ITEM NO.	L (mm)	W (mm)	H (mm)	Color (when inquiry please specify the color)	Packing (SET)
FG0040	47	19.5	15.5	white/brown/black	1000

Cap Knock-Down Connector series
FG0020

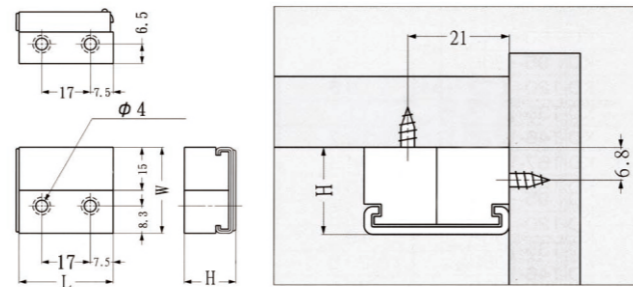

ITEM NO.	L (mm)	W (mm)	H (mm)	Color (when inquiry please specify the color)	Packing (SET)
FG0020	32	29	17	white/brown	1000

FG0080-37

FG0080-45

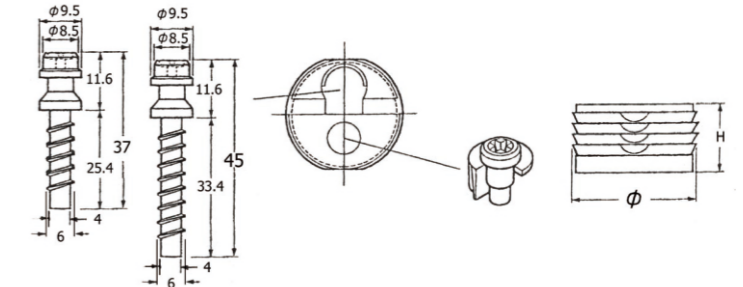

ITEM NO.	∅ (mm)	H (mm)	Color (when inquiry please specify the color)	Packing (SET)
FG0080-37	25.5	12	white/brown/black	1000
FG0080-45	25.5	12	white/brown/black	1000

Cap
FG0030

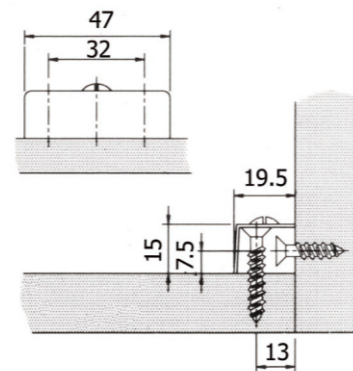

ITEM NO.	L (mm)	W (mm)	H (mm)	Color (when inquiry please specify the color)	Packing (SET)
FG0030	47	19.5	15.5	white/brown/black	1000

FG0080-1

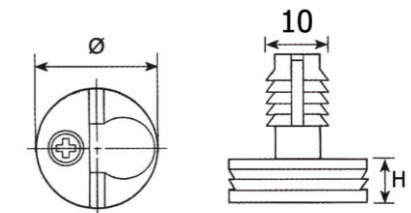

ITEM NO.	∅ (mm)	H (mm)	Color (when inquiry please specify the color)	Packing (SET)
FG0080-1	25.5	12	white/brown/black	1000



Knock-Down Connector series

FG0130

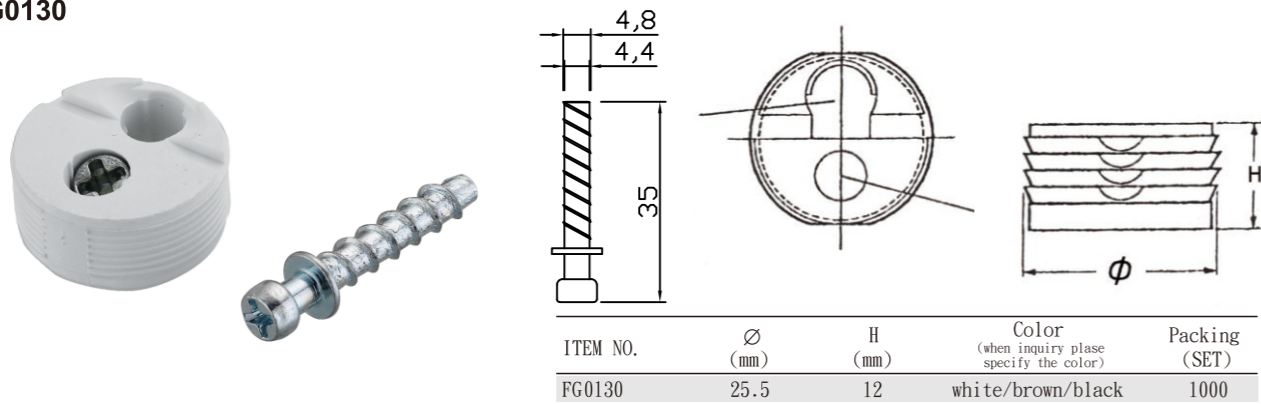

ITEM NO.	∅ (mm)	H (mm)	Color (when inquiry please specify the color)	Packing (SET)
FG0130	25.5	12	white/brown/black	1000

FG0090

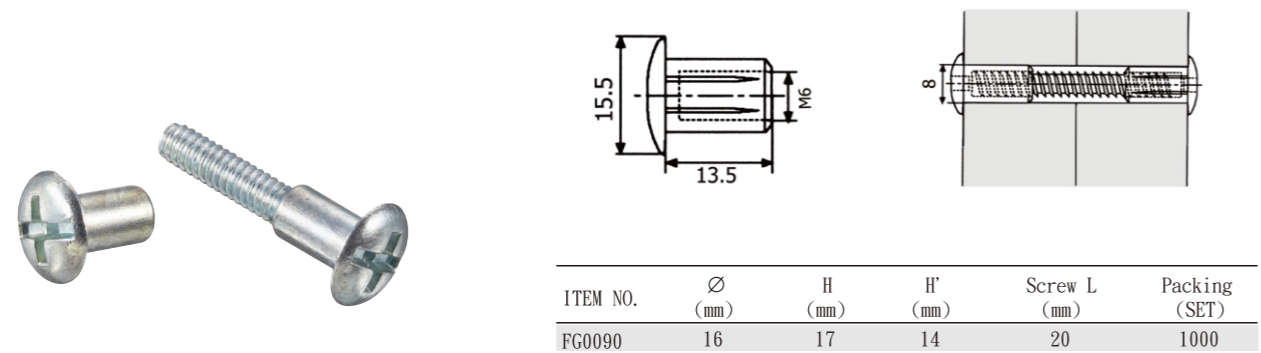

ITEM NO.	∅ (mm)	H (mm)	H' (mm)	Screw L (mm)	Packing (SET)
FG0090	16	17	14	20	1000

FG0100

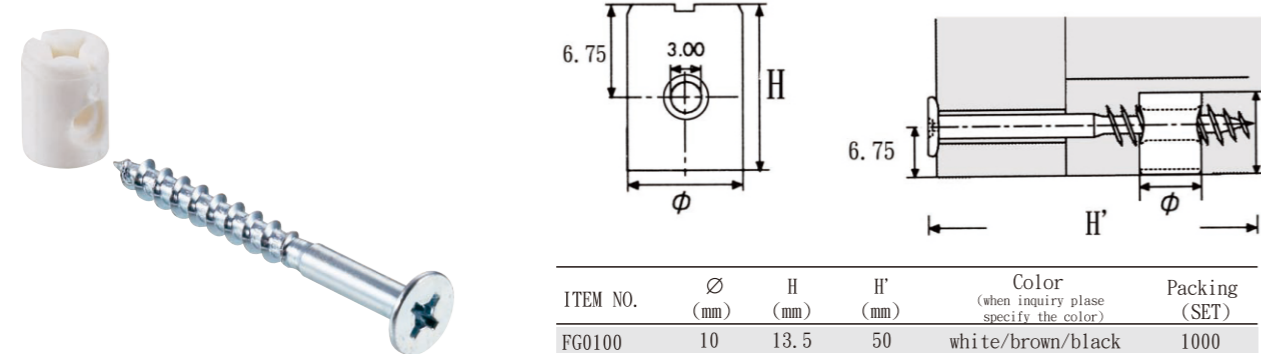

ITEM NO.	∅ (mm)	H (mm)	H' (mm)	Color (when inquiry please specify the color)	Packing (SET)
FG0100	10	13.5	50	white/brown/black	1000

FG0101

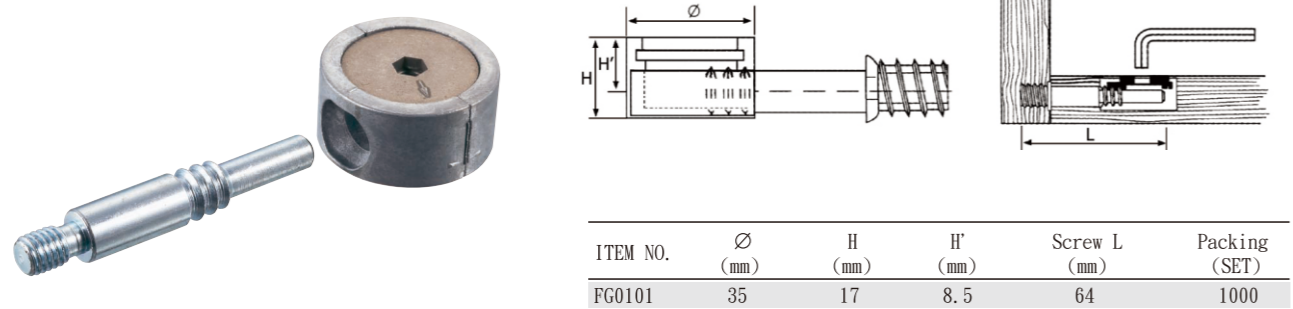

ITEM NO.	∅ (mm)	H (mm)	H' (mm)	Screw L (mm)	Packing (SET)
FG0101	35	17	8.5	64	1000



Knock-Down Connector series

FG1110

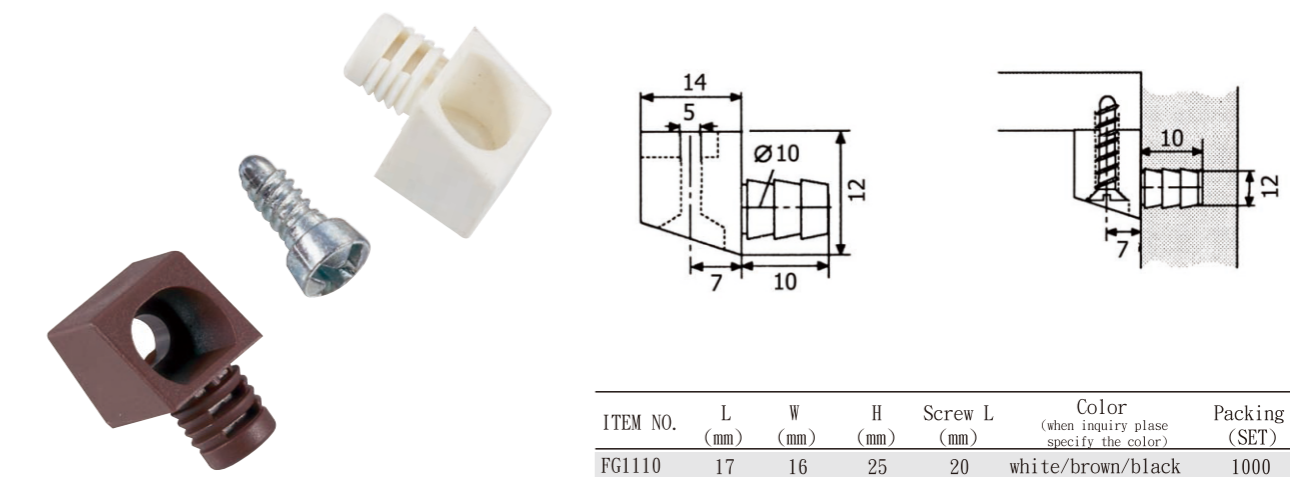

ITEM NO.	L (mm)	W (mm)	H (mm)	Screw L (mm)	Color (when inquiry please specify the color)	Packing (SET)
FG1110	17	16	25	20	white/brown/black	1000

FG1111-12

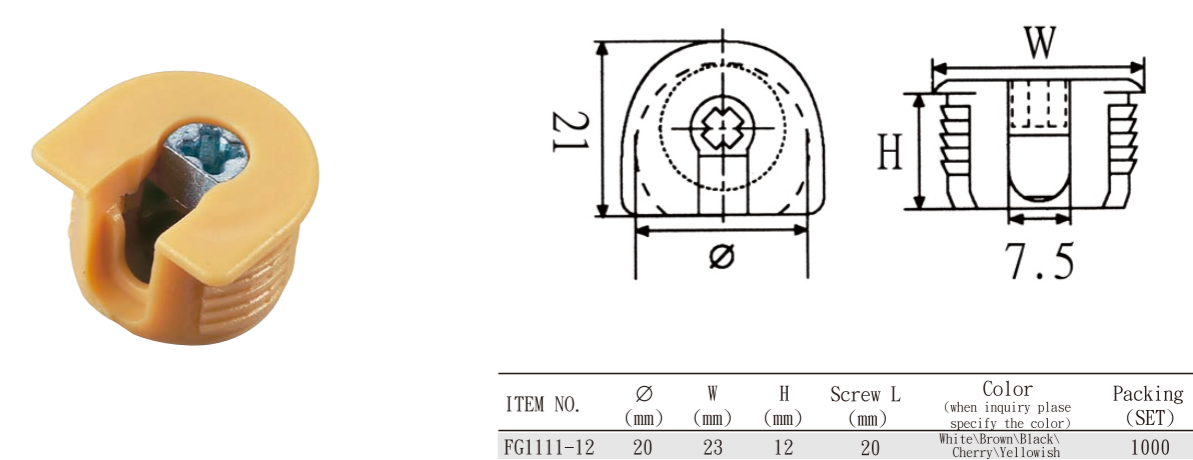

ITEM NO.	∅ (mm)	W (mm)	H (mm)	Screw L (mm)	Color (when inquiry please specify the color)	Packing (SET)
FG1111-12	20	23	12	20	White/Brown/Black/Cherry/Yellowish	1000

FG1112-Screw

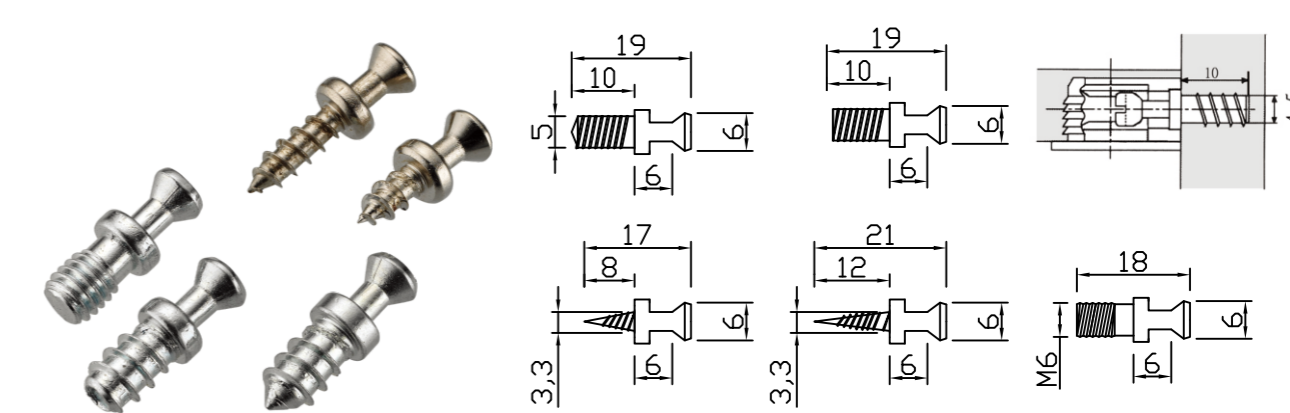

Hinge

Hinge



110° 35mm Hinge



110° 35mm Hinge

H02-00

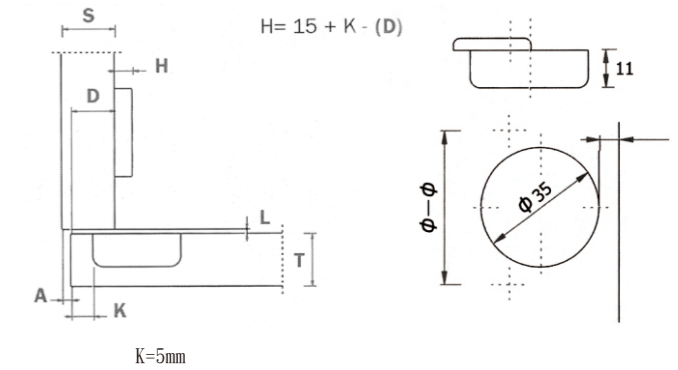

ITEM NO.	Ø-Ø (mm)	Weight (g)	Packing (pcs)
H02-00	52	64	200

H02-08

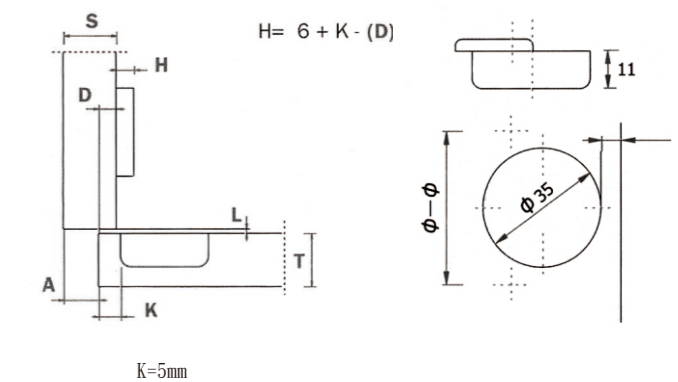

ITEM NO.	Ø-Ø (mm)	Weight (g)	Packing (pcs)
H02-08	52	64	200

H02-17

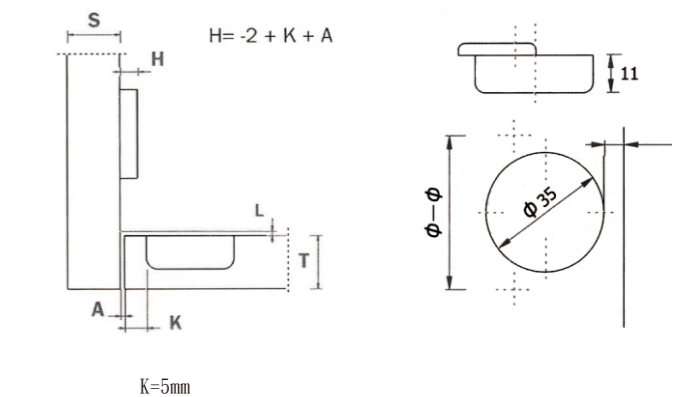

ITEM NO.	Ø-Ø (mm)	Weight (g)	Packing (pcs)
H02-17	52	67	200

S: thickness of the cabinet side
 D: required door overlay
 T: max. door thickness
 K: drilling distance
 A: reveal
 L: gap between door and carcass
 H: height of the mounting plate
 G: hinge constant



Hinge

110° 40mm Hinge

HN02-00

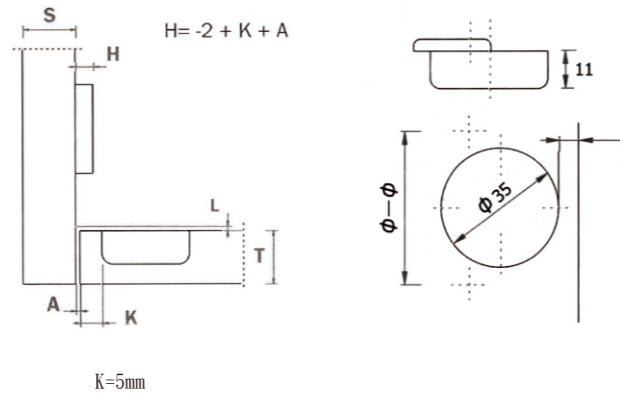

ITEM NO.	Ø-Ø (mm)	Weight (g)	Packing (pcs)
HN02-00	52	64.4	200

110° 40mm Hinge

H08-00

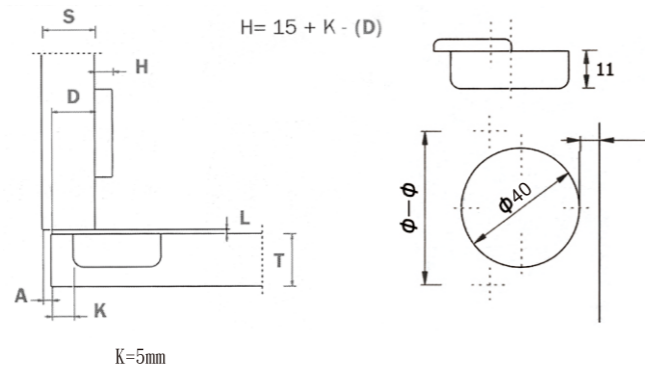
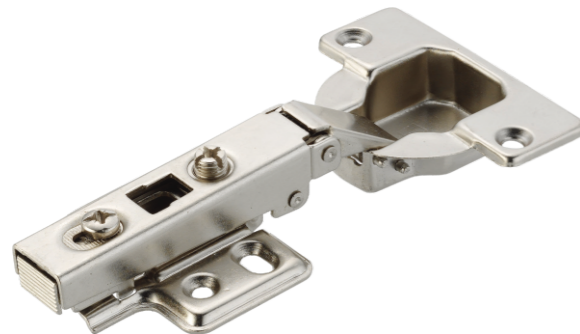

ITEM NO.	Ø-Ø (mm)	Weight (g)	Packing (pcs)
H08-00	52	85	200

H08-08

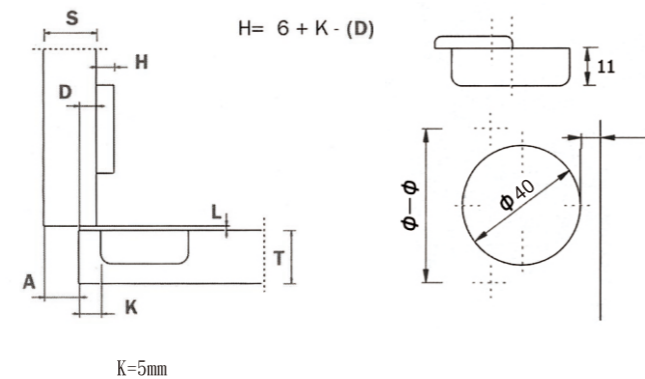

ITEM NO.	Ø-Ø (mm)	Weight (g)	Packing (pcs)
H08-08	52	89	200

Hinge



110° 35mm Hinge/Quickly Positions Hinge

HN23-00

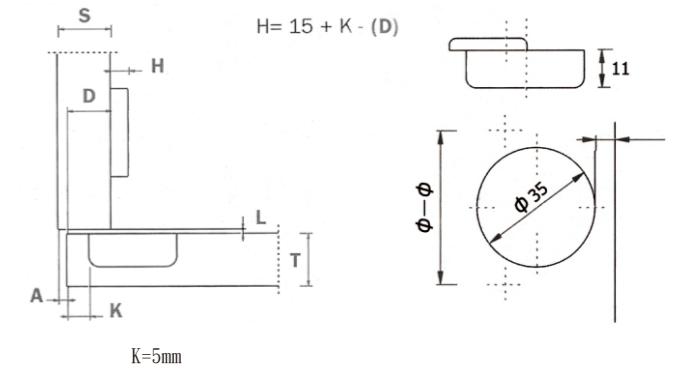
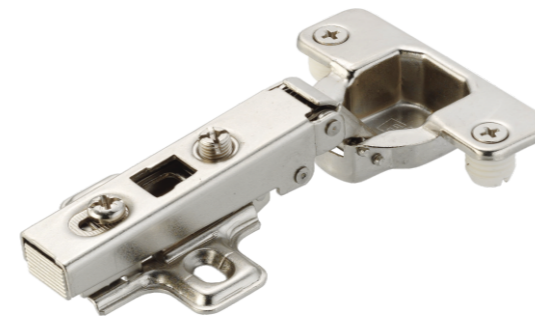

ITEM NO.	Ø-Ø (mm)	Weight (g)	Packing (pcs)
HN23-00	52	79	200

HN23-08

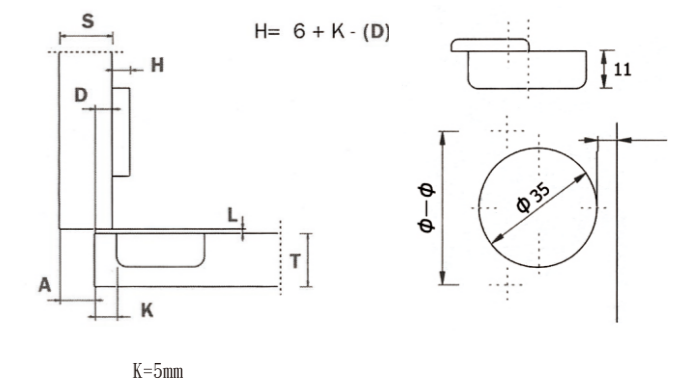

ITEM NO.	Ø-Ø (mm)	Weight (g)	Packing (pcs)
HN23-08	52	79	200

HN23-17

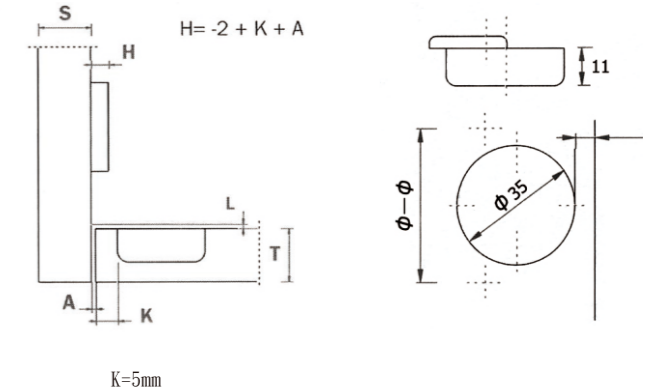

ITEM NO.	Ø-Ø (mm)	Weight (g)	Packing (pcs)
HN23-17	52	82	200



Hinge

110° 35mm Soft-Close Hinge With Nut

HCN15-00

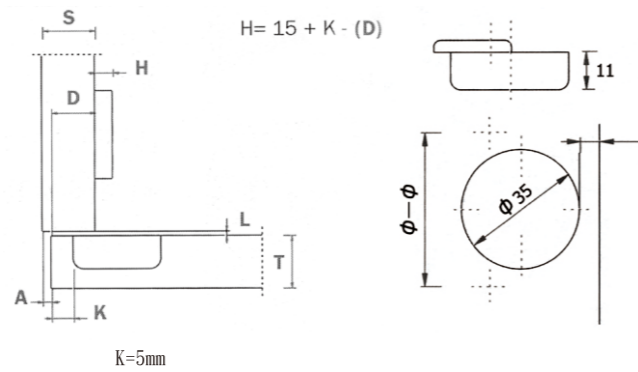
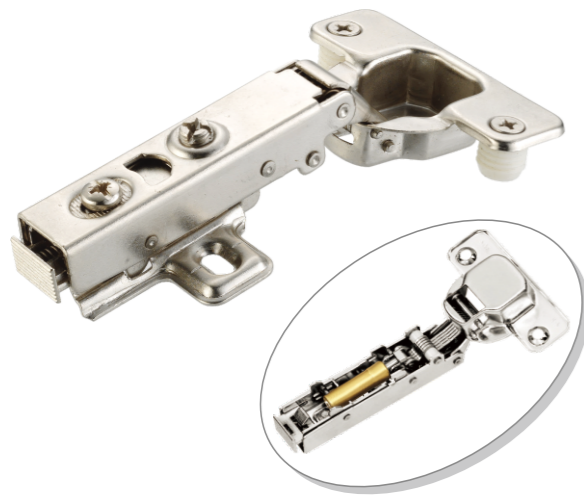

ITEM NO.	Ø-Ø (mm)	Weight (g)	Packing (pcs)
HCN15-00	52	94	200

HCN15-08

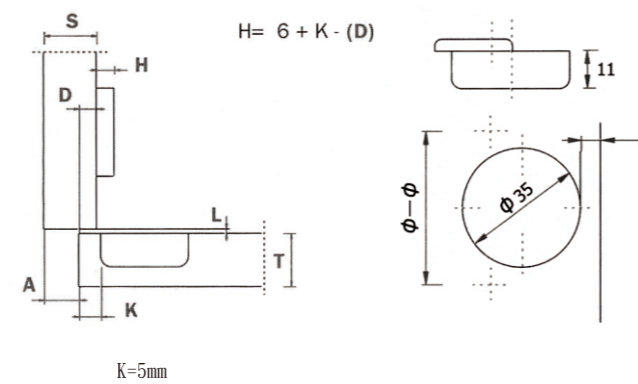
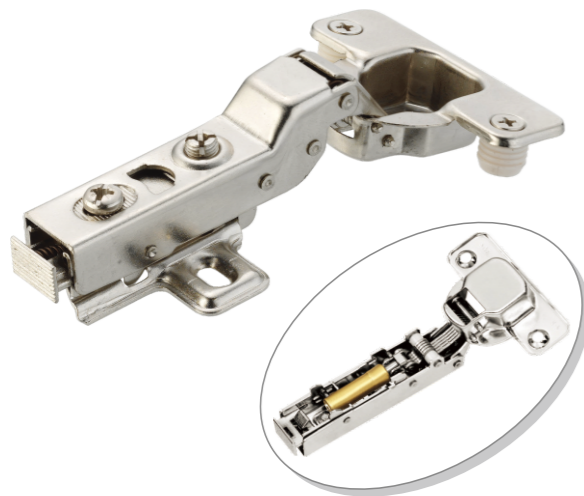

ITEM NO.	Ø-Ø (mm)	Weight (g)	Packing (pcs)
HCN15-08	52	98	200

HCN15-17

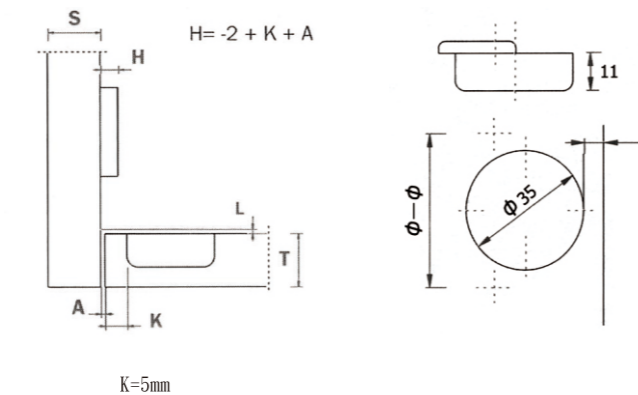
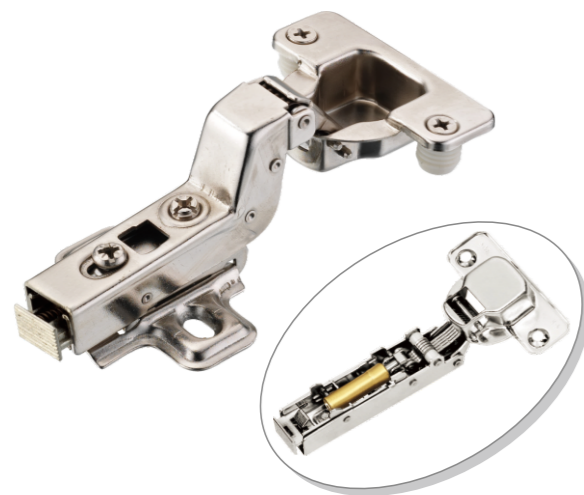

ITEM NO.	Ø-Ø (mm)	Weight (g)	Packing (pcs)
HCN15-17	52	102	200

Hinge



110° 35mm 3D Hinge

H3D16-00

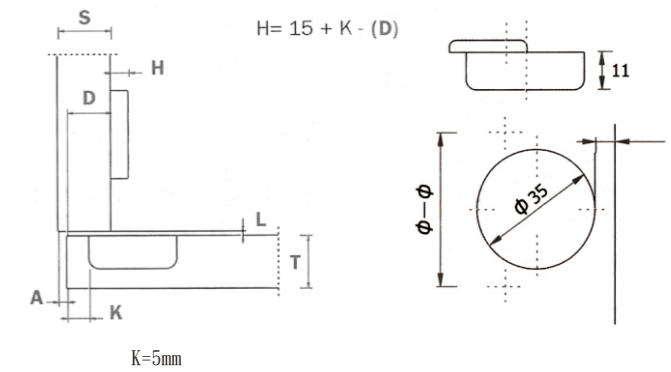

ITEM NO.	Ø-Ø (mm)	Weight (g)	Packing (pcs)
H3D16-00	52	114	200

H3D16-08

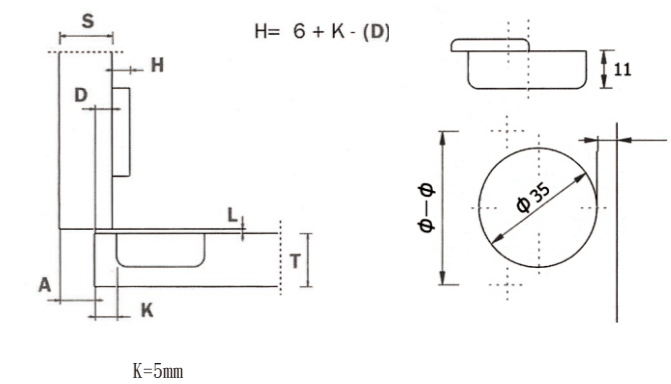

ITEM NO.	Ø-Ø (mm)	Weight (g)	Packing (pcs)
H3D16-08	52	114	200

HNT32-5

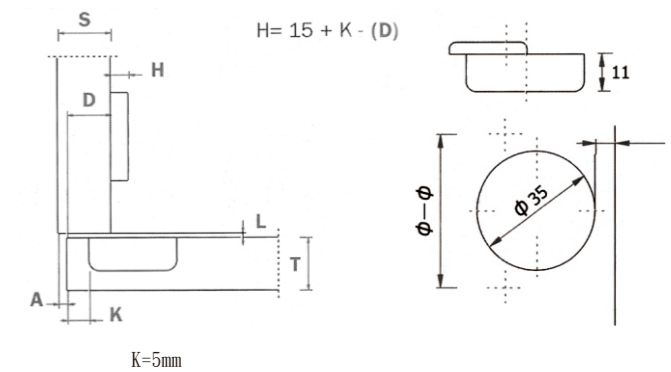

ITEM NO.	Ø-Ø (mm)	Weight (g)	Packing (pcs)
HNT32-5	52	70	200



Hinge

Mini-Hinge/Aluminium Hinge

Mini-Hinge

H26-6

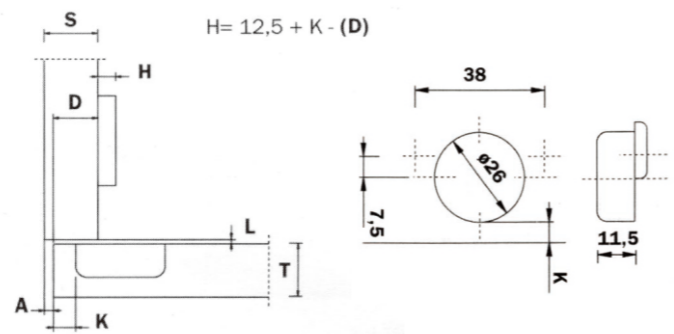
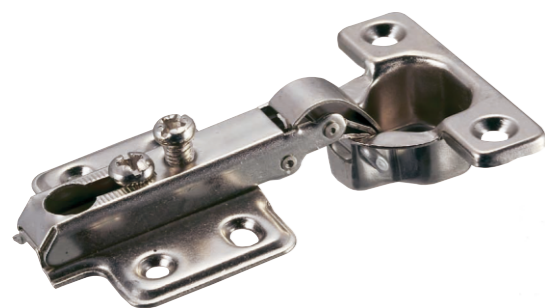

ITEM NO.	Ø-Ø (mm)	Weight (g)	Packing (pcs)
H26-6	38	43.4	400

Mini-Hinge

H26-3

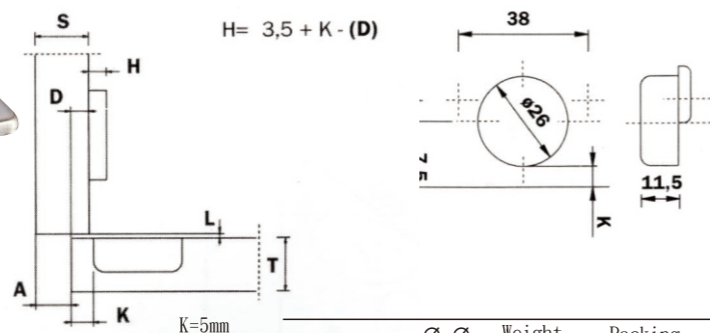

ITEM NO.	Ø-Ø (mm)	Weight (g)	Packing (pcs)
H26-3	38	44.6	400

H26-17

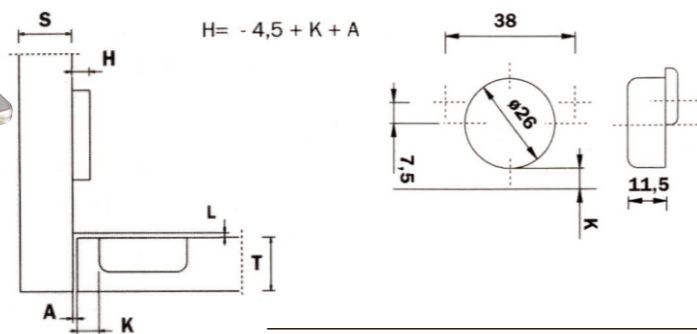

ITEM NO.	Ø-Ø (mm)	Weight (g)	Packing (pcs)
H26-17	38	45.2	400

Hinge



Mini-Hinge/Aluminium Hinge

Aluminium Hinge

HA-6

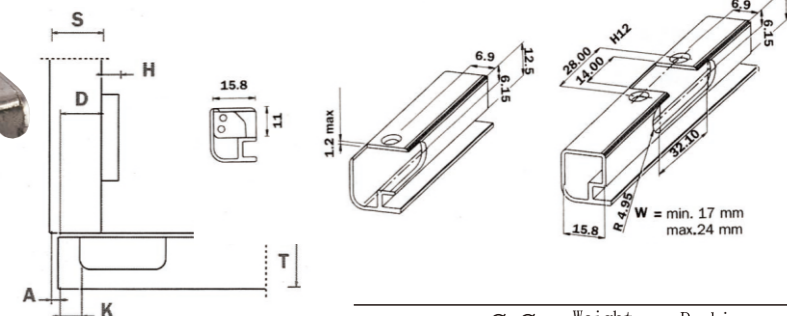

ITEM NO.	Ø-Ø (mm)	Weight (g)	Packing (pcs)
HA-6	28	62.8	200

HA-3

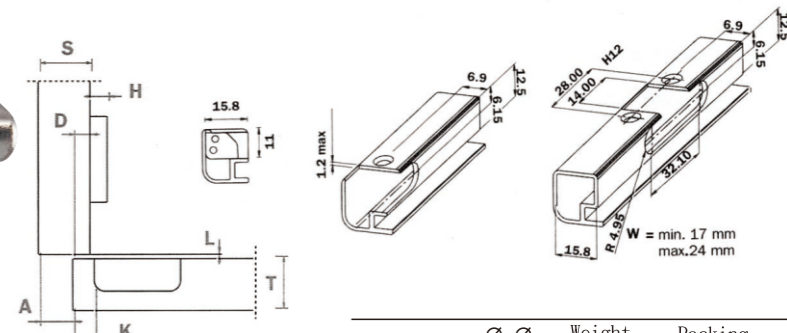

ITEM NO.	Ø-Ø (mm)	Weight (g)	Packing (pcs)
HA-3	28	64.4	200

HA-17

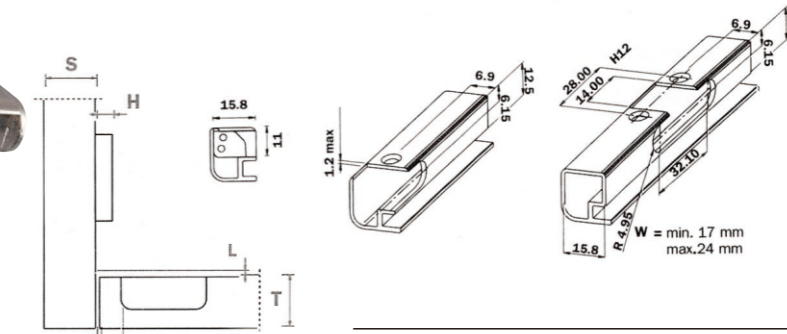

ITEM NO.	Ø-Ø (mm)	Weight (g)	Packing (pcs)
HA-17	28	66.4	200



Hinge

Glass-Hinge

DH010

ITEM NO.	Weight (g)	Packing (pcs)
DH010	53.4	250

DH011

ITEM NO.	Weight (g)	Packing (pcs)
DH011	75	250

DH012

ITEM NO.	Weight (g)	Packing (pcs)
DH012	78	200

DH013

ITEM NO.	Weight (g)	Packing (pcs)
DH013	74.8	250

DH014

ITEM NO.	Weight (g)	Packing (pcs)
DH014	42	250

Hinge



Glass-Hinge/Spring-Hinge

Glass-Hinge DH015

ITEM NO.	Weight (g)	Packing (pcs)
DH015	11.6	500

DH016

ITEM NO.	Weight (g)	Packing (pcs)
DH016	4	1000

DH017

ITEM NO.	Weight (g)	Packing (pcs)
DH017	12	1000

Spring-Hinge H-500

ITEM NO.	Weight (g)	Packing (pcs)
H-500	42	500

H-514

ITEM NO.	A (mm)	B (mm)	ø-ø (mm)	Weight (g)	Packing (pcs)
H-513	50	75	15	59	500
H-514	32	52	10.5	40	500

H-600

ITEM NO.	Weight (g)	Packing (pcs)
H-600	58.2	300



Hinge

Spring-Hinge

SH-01



ITEM NO.	Weight (g)	Packing (pcs)
SH-01	6	1000

SH-02

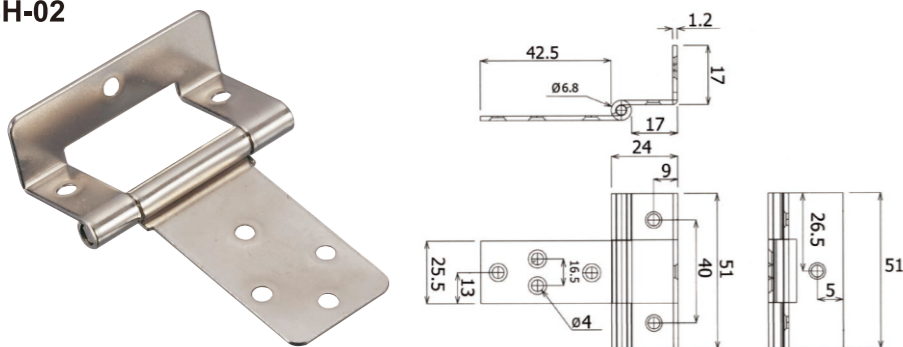

ITEM NO.	Weight (g)	Packing (pcs)
SH-02	31.2	1000

SH-03

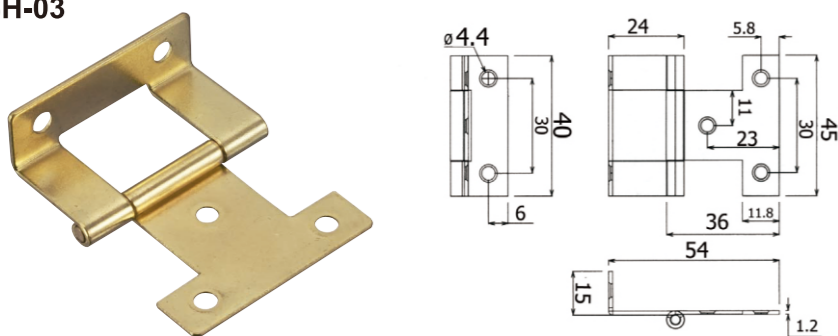

ITEM NO.	Weight (g)	Packing (pcs)
SH-03	21.8	1000

SH-04

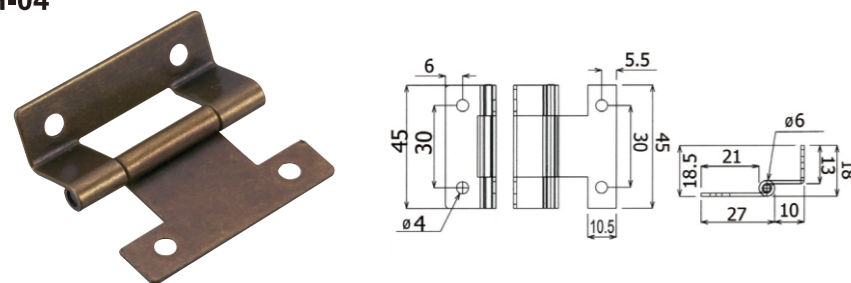

ITEM NO.	Weight (g)	Packing (pcs)
SH-04	25.2	1000

SH-05

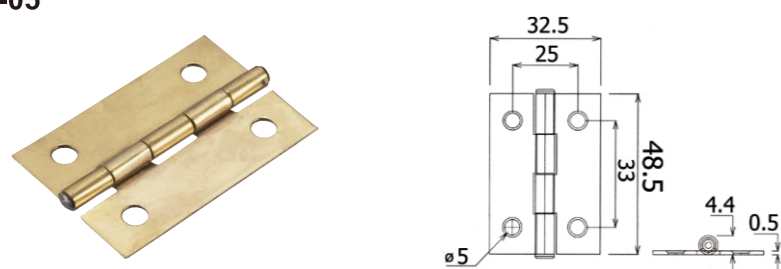

ITEM NO.	Weight (g)	Packing (pcs)
SH-05	11	1000

Hinge



Spring-Hinge

SH-06

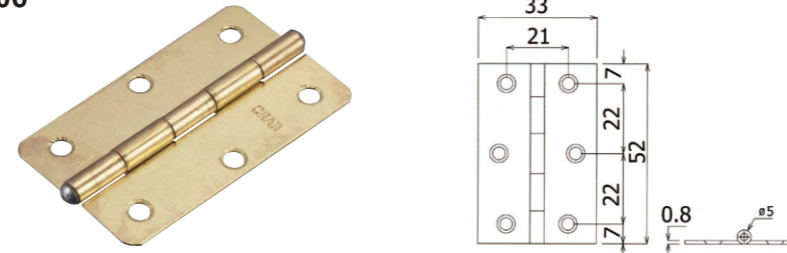

ITEM NO.	Weight (g)	Packing (pcs)
SH-06	18.6	1000

SH-07

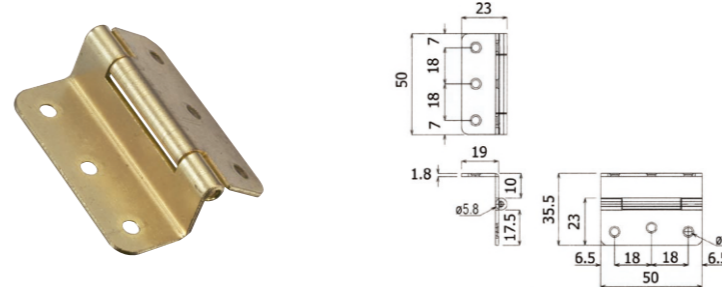

ITEM NO.	Weight (g)	Packing (pcs)
SH-07	37.6	1000

SH-08

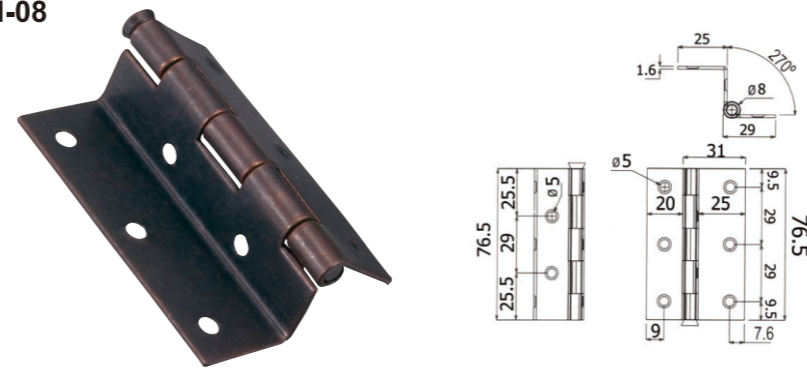

ITEM NO.	Weight (g)	Packing (pcs)
SH-08	82.6	1000

SH-09

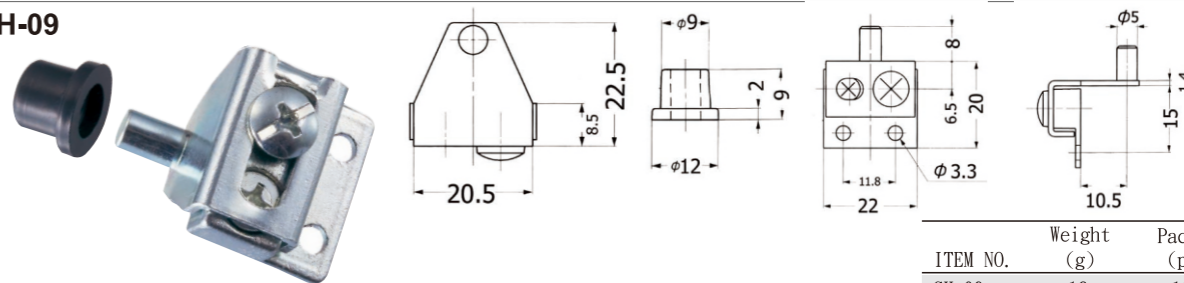

ITEM NO.	Weight (g)	Packing (pcs)
SH-09	18	1000

SH-10

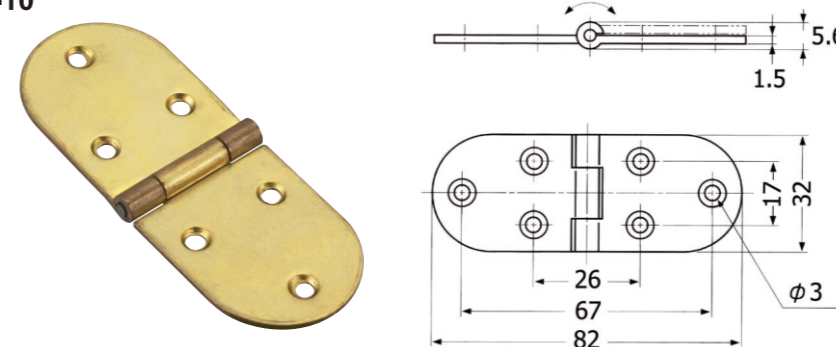

ITEM NO.	Weight (g)	Packing (pcs)
SH-10	32.8	1000



Hinge

Spring-Hinge/Frog-Hinge/Drill In Concealed Hinge

Slide

Spring-Hinge

SH-11

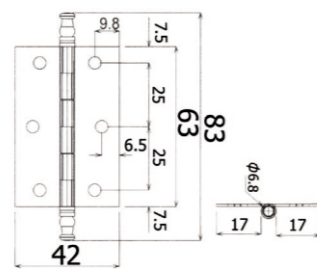

ITEM NO.	Weight (g)	Packing (pcs)
SH-11	65.8	1000

SH-12

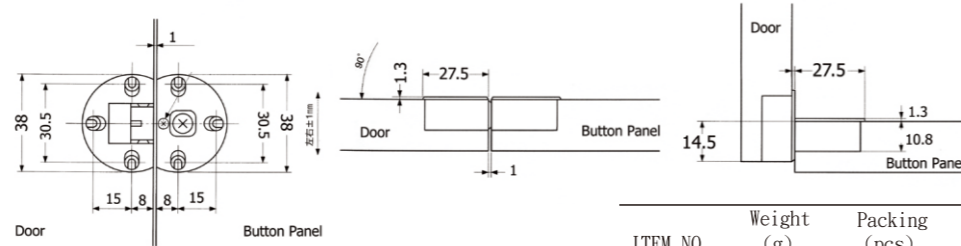

ITEM NO.	Weight (g)	Packing (pcs)
SH-12	56	1000

Frog-Hinge

HF01

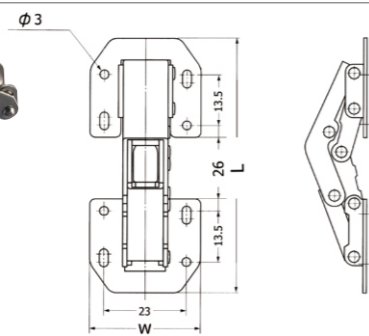

ITEM NO.	L (mm)	W (g)	Packing (pcs)
HF01	82	31	1000

HF02

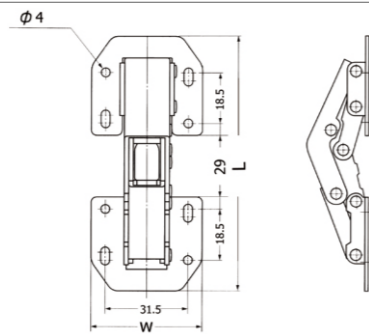

ITEM NO.	L (mm)	W (g)	Packing (pcs)
HF02	105	42	500

Drill In Concealed Hinge

HS01

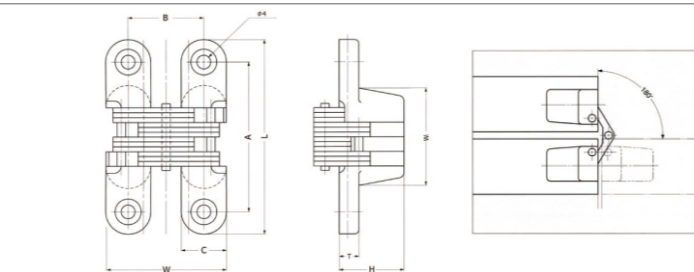

ITEM NO.	L (mm)	W (mm)	A (mm)	B (mm)	C (mm)	T (mm)	W1 (mm)	H (mm)	Packing (pcs)
HS01	44.0	34.0	31.0	23.0	12.5	5.0	18.0	18.5	200
HS02	60.0	34.5	47.5	21.5	12.5	6.0	37.0	17.5	200
HS03	94.0	52.0	77.5	32.0	18.5	9.0	52.0	27.0	200





Slide

Ball Bearing Slide/45mm Full Extension Ball Slide/ Concealed Slide

Ball Bearing Slide

2700

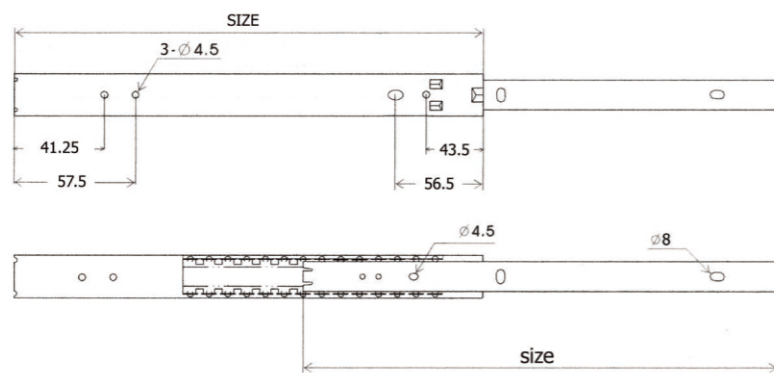

ITEM NO.	Size (mm)	Load Rating Weight(kg)
2700	300(12")	15
	350(14")	15
	400(16")	15
	450(18")	15
	500(20")	15



Slide



45mm Full Extension Ball Slide/Concealed Slide

45mm Full Extension Ball Slide

4500

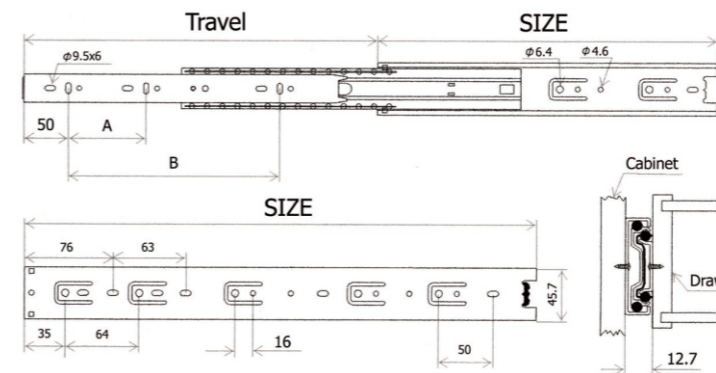

ITEM NO.	Size (mm)	A (mm)	B (mm)	Travel (mm)	Load Rating Weight(kg)
4500	300(12")	88	224	305	45
	350(14")	108	255	356	45
	400(16")	135	320	406	45
	450(18")	160	352	457	45
	500(20")	192	416	508	45
	550(22")	210	474	559	45
	600(24")	235	511	610	45
	650(26")	260	576	660	45
	700(28")	280	576	711	45

2701

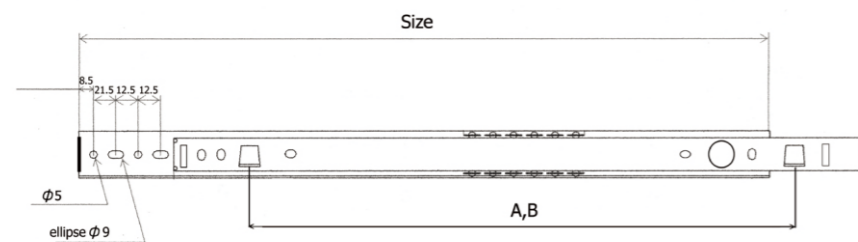

ITEM NO.	Size (mm)	A (mm)	B (mm)	Load Rating Weight(kg)
2701	300(12")	182	258	15
	350(14")	182	258	15
	400(16")	182	258	15
	450(18")	182	258	15
	500(20")	182	258	15

Concealed Slide

4501

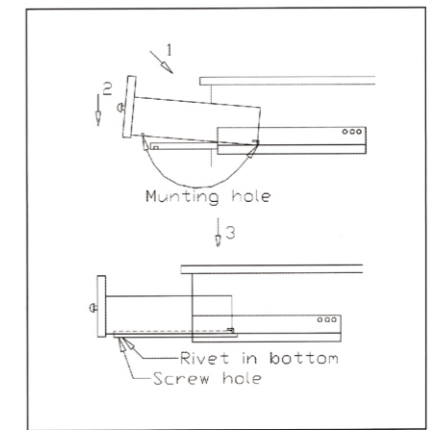
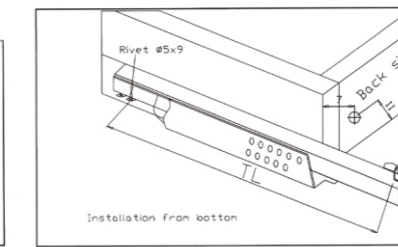
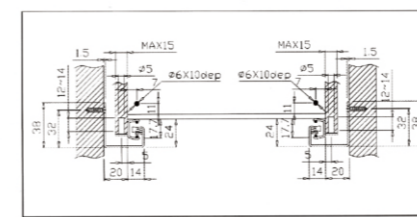

ITEM NO.	Size (mm)	Load Rating Weight(kg)
4501	400(16")	30
	450(18")	30



Slide

Drawer Slide Set

Fix-Closing Drawer Slide

602



ITEM NO.	Size (mm)	Load Rating Weight(kg)
602	250(10")	10
	300(12")	10
	350(14")	10
	400(16")	10
	450(18")	10
	500(20")	10
	550(22")	10

Drawer profiles are pe-drilled for side or bottom screw attachment

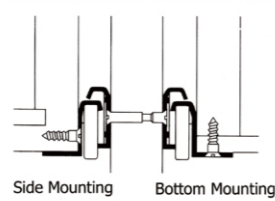

Drawer Box Attachment

Guide ribs prevent rollers from touching the mounting screws

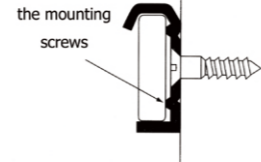

Cabinet Profile Guide Ribs

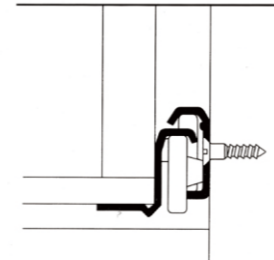

Drawer Bottoms Fit Tight

Self-Closing Drawer Slide

604



ITEM NO.	Size (mm)	Load Rating Weight(kg)
604	250(10")	10
	300(12")	10
	400(16")	10
	450(18")	10
	500(20")	10
	550(22")	10

Drawer profiles are pe-drilled for side or bottom screw attachment

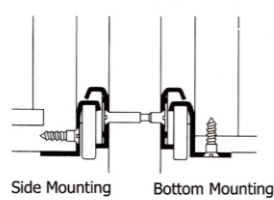

Drawer Box Attachment

Guide ribs prevent rollers from touching the mounting screws

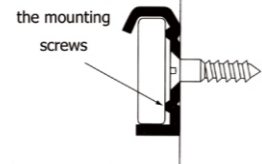

Cabinet Profile Guide Ribs

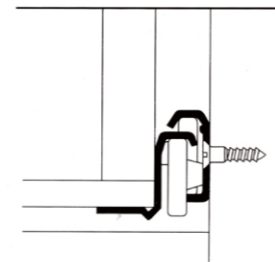

Drawer Bottoms Fit Tight

Slide



Drawer Slide Set

Green Wheel Self-Closing Drawer Slide

2606



Reduce the noise when opening and closing the drawer.

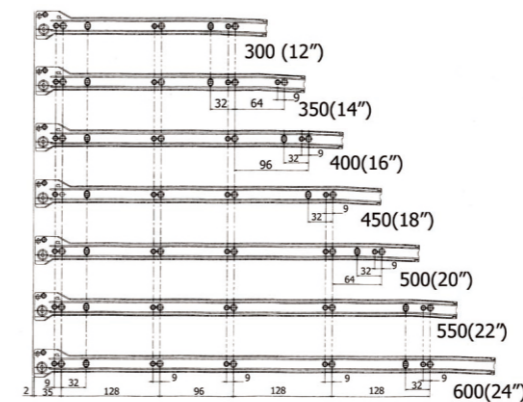

ITEM NO.	Size (mm)	Load Rating Weight(kg)
2606	250(10")	10
	300(12")	10
	350(14")	10
	400(16")	10
	450(18")	10
	500(20")	10
	550(22")	10

Metal Box Drawer Slide

2607

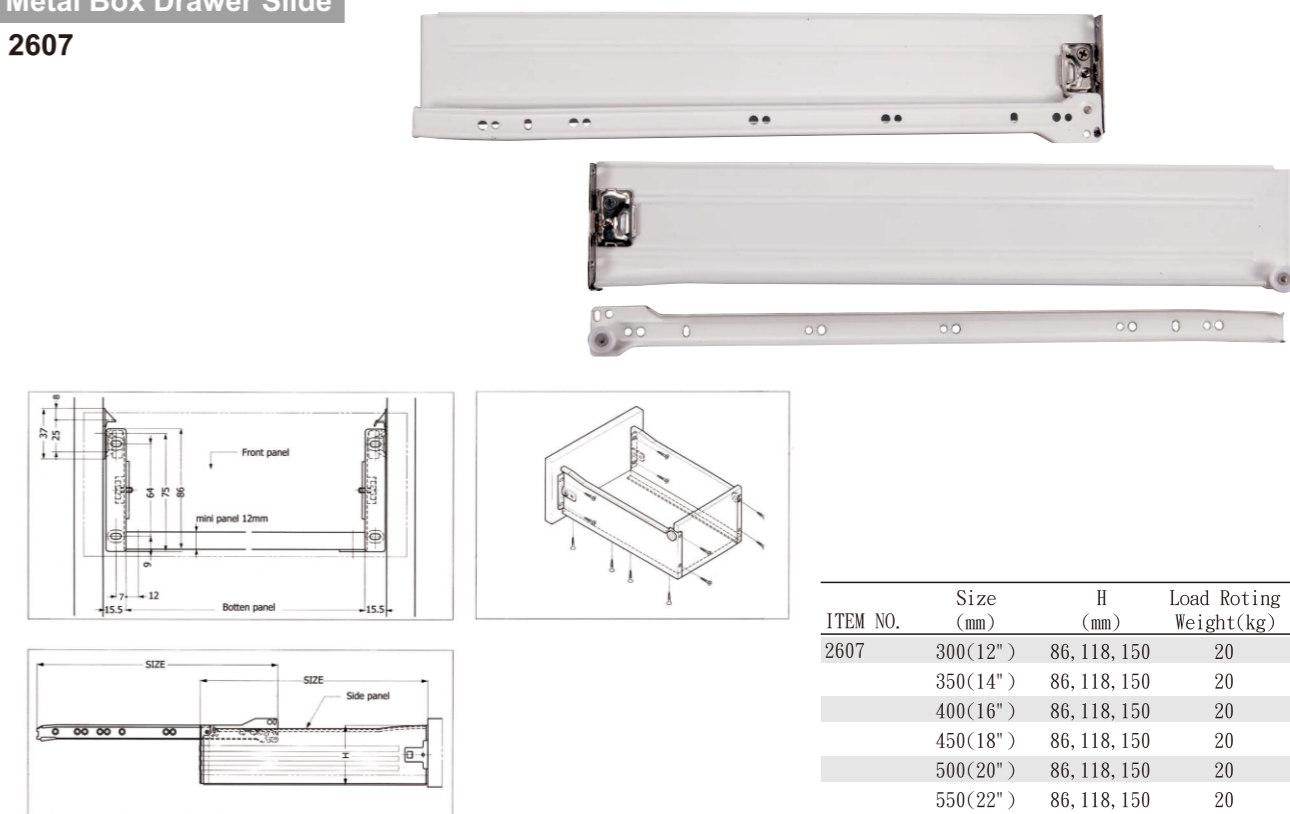

ITEM NO.	Size (mm)	H (mm)	Load Rating Weight(kg)
2607	300(12")	86, 118, 150	20
	350(14")	86, 118, 150	20
	400(16")	86, 118, 150	20
	450(18")	86, 118, 150	20
	500(20")	86, 118, 150	20
	550(22")	86, 118, 150	20



Slide

Plastic Slide

FG0101

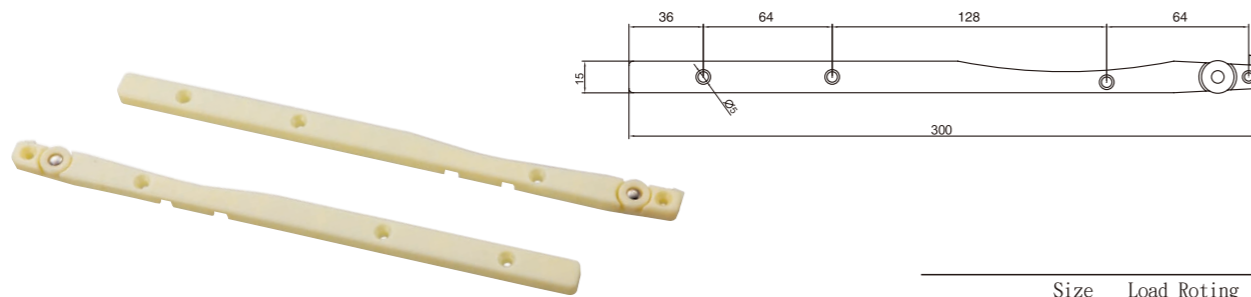

ITEM NO.	Size (mm)	Load Rating Weight(kg)
FG0101	300	10

FG0102

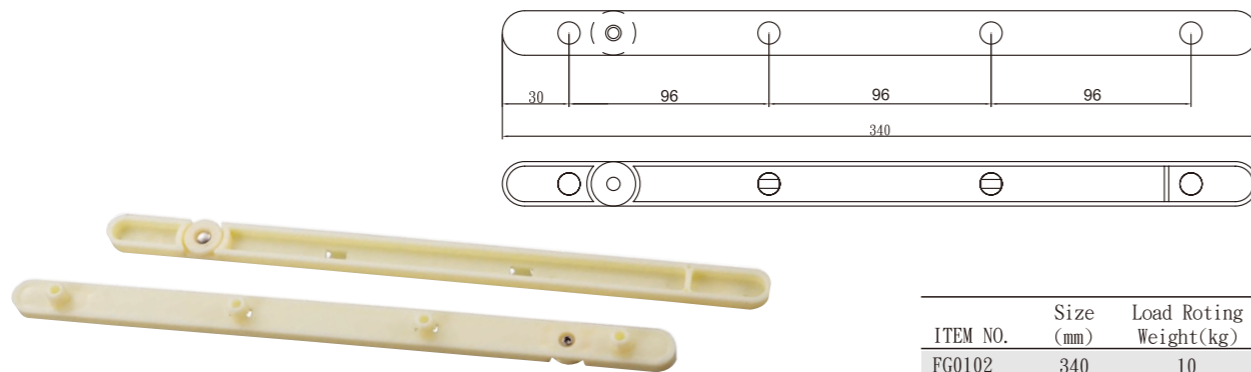

ITEM NO.	Size (mm)	Load Rating Weight(kg)
FG0102	340	10

FG0103



ITEM NO.	Size (mm)	Load Rating Weight(kg)
FG0103	280	5

FG0104

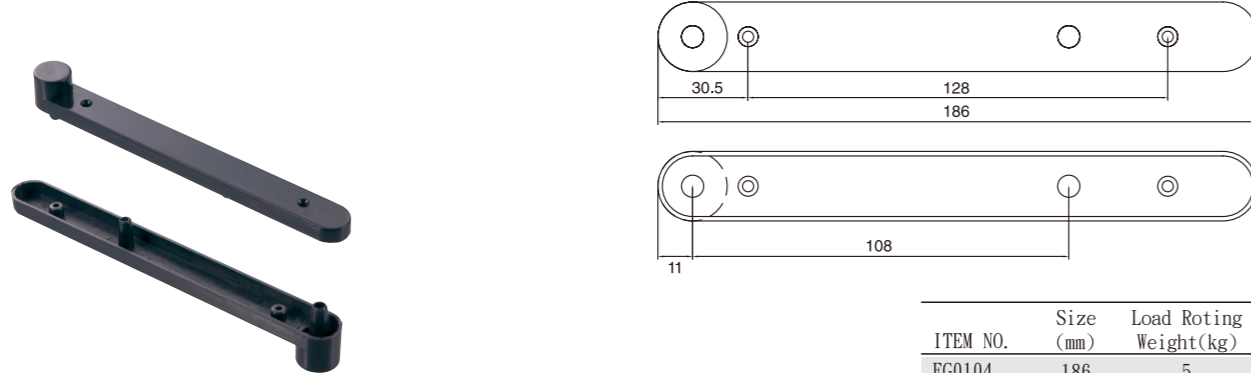

ITEM NO.	Size (mm)	Load Rating Weight(kg)
FG0104	186	5

Slide



Plastic Slide

FG0105

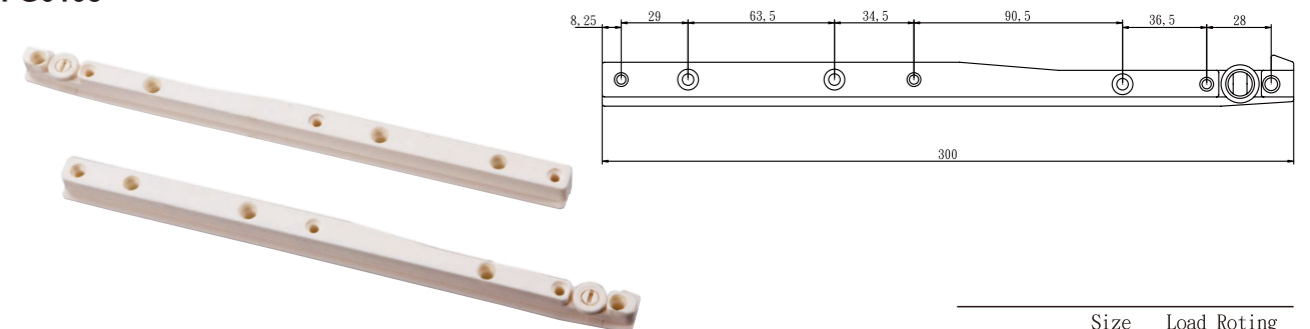

ITEM NO.	Size (mm)	Load Rating Weight(kg)
FG0105	300	10

FG0106

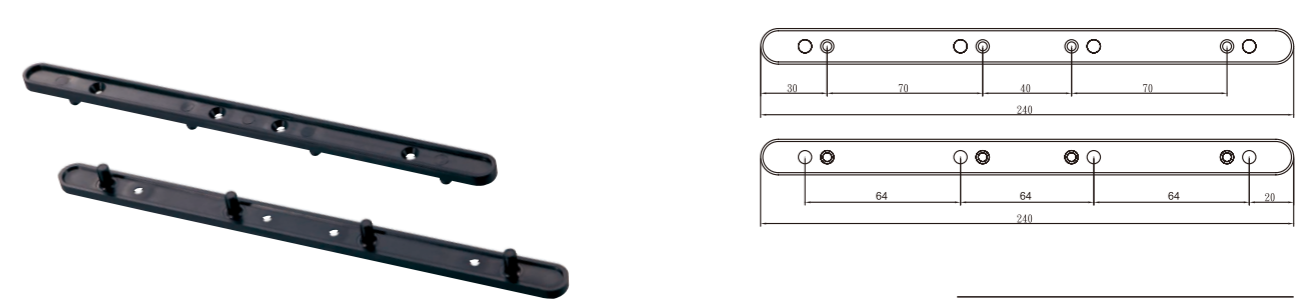

ITEM NO.	Size (mm)	Load Rating Weight(kg)
FG0105	240	5

FG0107

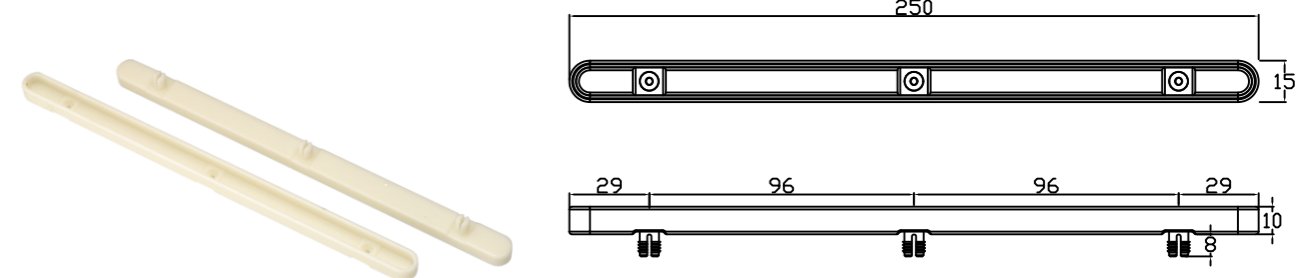

ITEM NO.	Size (mm)	Load Rating Weight(kg)
FG0105	250	5

FG0108

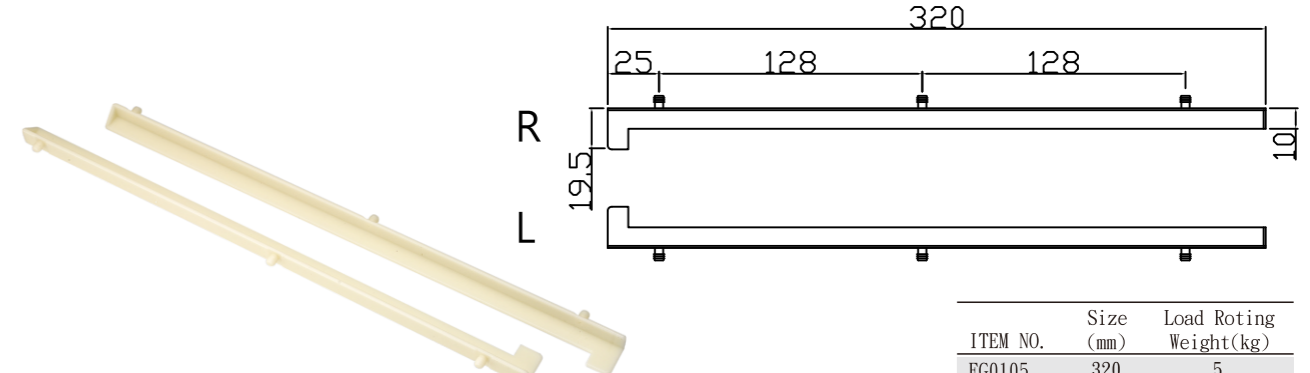

ITEM NO.	Size (mm)	Load Rating Weight(kg)
FG0105	320	5

Sliding Door Fitting

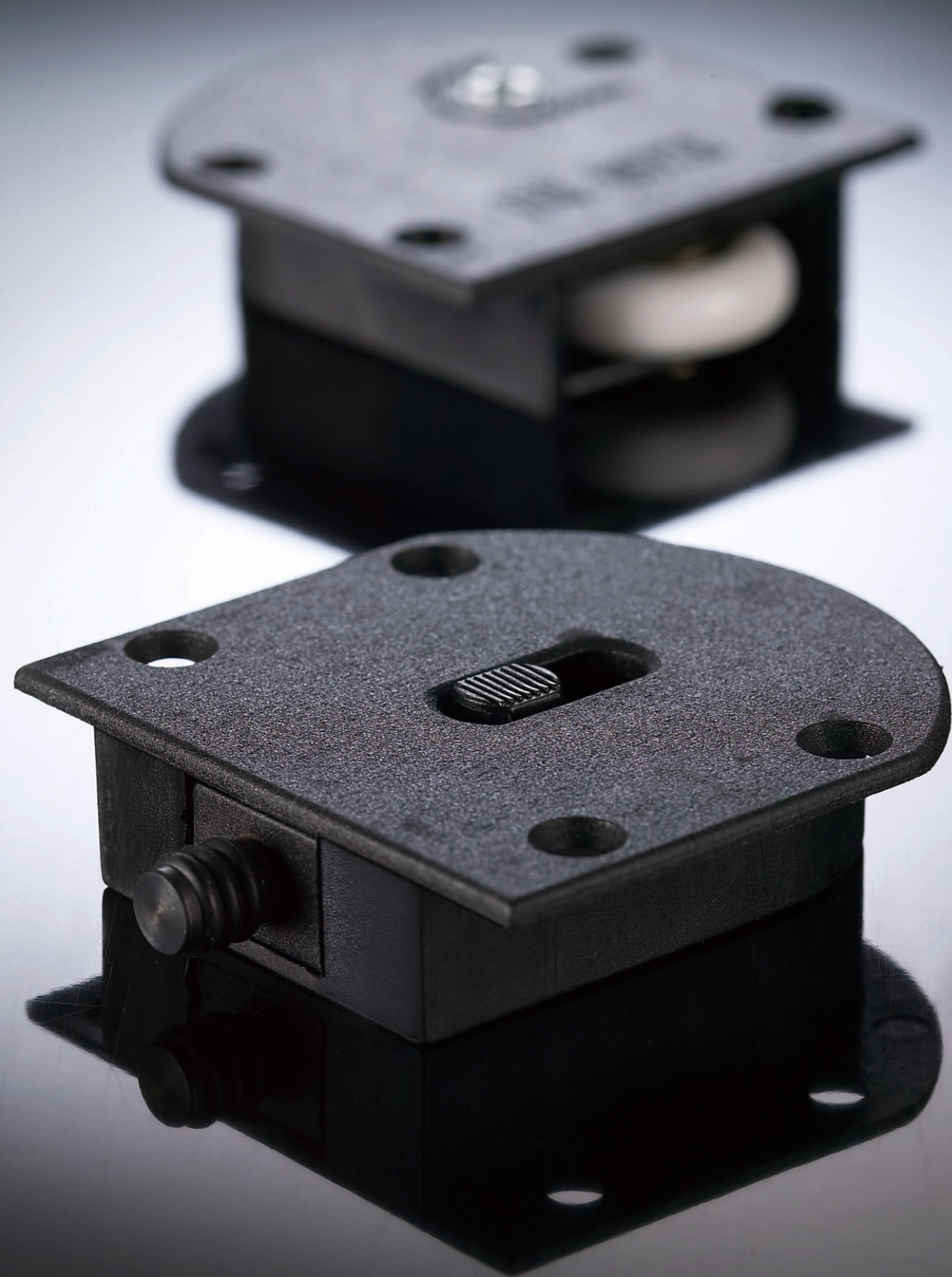

Top Guide & Lower Roller

W-001



Use screwdriver
up and down

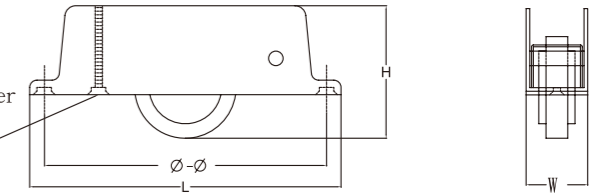

ITEM NO.	L (mm)	W (mm)	H (mm)	Ø-Ø (mm)	Weight (g)	Packing (pcs)
W-001	86	17.0	24.5	76.5	57.8	500

W-002



Use screwdriver
up and down

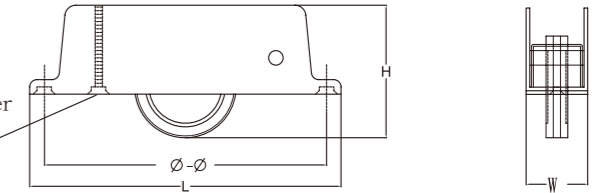

ITEM NO.	L (mm)	W (mm)	H (mm)	Ø-Ø (mm)	Weight (g)	Packing (pcs)
W-002	86	17.0	24.5	76.5	58.0	500

W-003



Use screwdriver
up and down

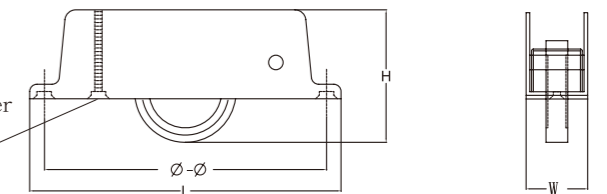

ITEM NO.	L (mm)	W (mm)	H (mm)	Ø-Ø (mm)	Weight (g)	Packing (pcs)
W-003	86	17.0	24.5	76.5	57.6	500

W-004

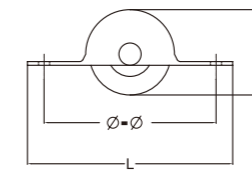

ITEM NO.	L (mm)	W (mm)	H (mm)	Ø-Ø (mm)	Weight (g)	Packing (pcs)
W-004	55	8.5	19.5	46.5	9.4	1000

W-005

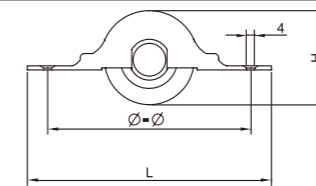

ITEM NO.	L (mm)	W (mm)	H (mm)	Ø-Ø (mm)	Weight (g)	Packing (pcs)
W-005	60	12.5	23.5	50.5	21.4	1000

W-006

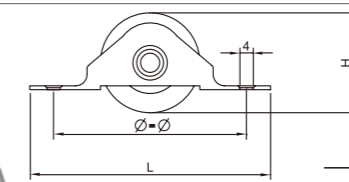

ITEM NO.	L (mm)	W (mm)	H (mm)	Ø-Ø (mm)	Weight (g)	Packing (pcs)
W-006	63	11.5	26.0	51.0	19.4	1000

Top Guide & Lower Roller/Caster

Top Guide & Lower Roller

W-007

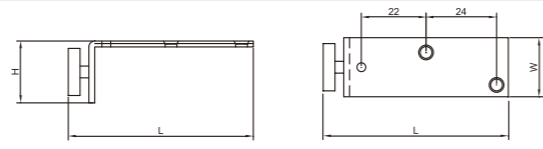

ITEM NO.	L (mm)	W (mm)	H (mm)	Weight (g)	Packing (pcs)
W-007	63	20.0	21.0	27.6	1000

W-008

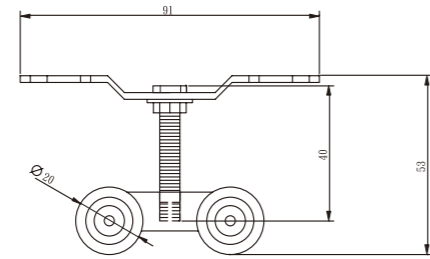

ITEM NO.	L (mm)	W (mm)	H (mm)	Weight (g)	Packing (pcs)
W-008	91	26.0	50.0	98.2	500

Caster

4101

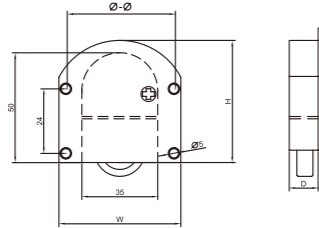

ITEM NO.	W (mm)	D (mm)	H (mm)	Ø-Ø (mm)	Weight (g)	Packing (pcs)
4101	53	12.0	53.0	43	45.6	250

4201

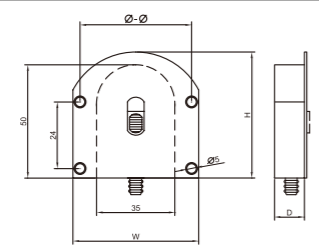
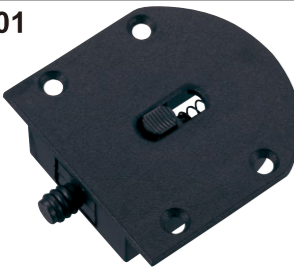

ITEM NO.	W (mm)	D (mm)	H (mm)	Ø-Ø (mm)	Weight (g)	Packing (pcs)
4201	53	12.0	53.0	43	17.0	250

4102

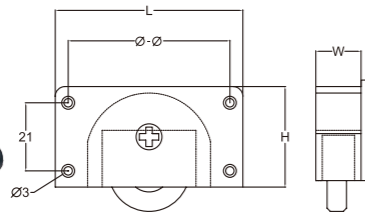

ITEM NO.	L (mm)	W (mm)	H (mm)	Ø-Ø (mm)	Weight (g)	Packing (pcs)
4102	58	14.0	31.5	46	35.6	250

4202

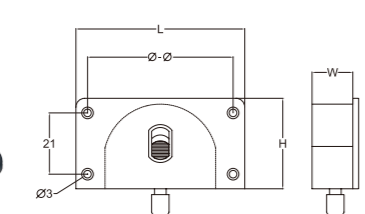

ITEM NO.	L (mm)	W (mm)	H (mm)	Ø-Ø (mm)	Weight (g)	Packing (pcs)
4202	58	14.0	31.5	43	11.4	250



Caster

FC01-400

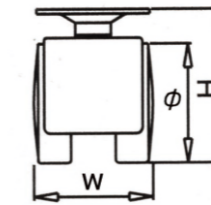

ITEM NO.	W (mm)	H (mm)	Ø (mm)	Weight (g)
FC01-400	40	55	40	69.0

FC01-401

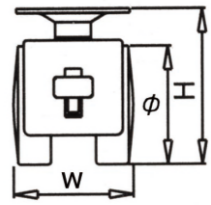

ITEM NO.	W (mm)	H (mm)	Ø (mm)	Weight (g)
FC01-401	40	55	40	70.0

FC02-400

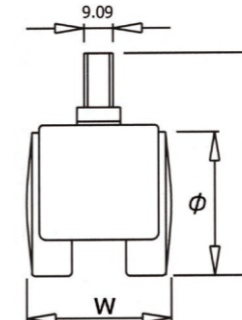

ITEM NO.	W (mm)	H (mm)	Ø (mm)	Weight (g)
FC02-400	40	70	40	56.0

FC02-401

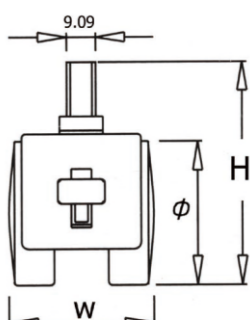

ITEM NO.	W (mm)	H (mm)	Ø (mm)	Weight (g)
FC02-401	40	70	40	62.8

FC03-400

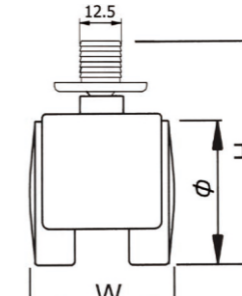

ITEM NO.	W (mm)	H (mm)	Ø (mm)	Weight (g)
FC03-400	40	64	40	45.2

FC03-401

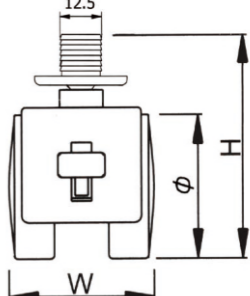

ITEM NO.	W (mm)	H (mm)	Ø (mm)	Weight (g)
FC03-401	40	64	40	54.2

FC04-500

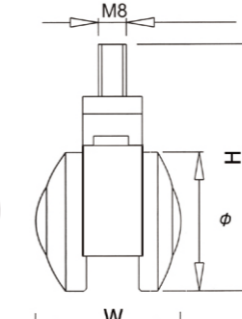

ITEM NO.	W (mm)	H (mm)	Ø (mm)	Weight (g)
FC04-500	46	76	50	164.0

FC04-501

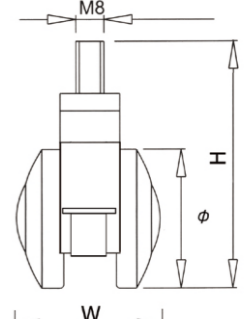

ITEM NO.	W (mm)	H (mm)	Ø (mm)	Weight (g)
FC04-501	46	76	50	176.6

Caster

Catch

FC05-500

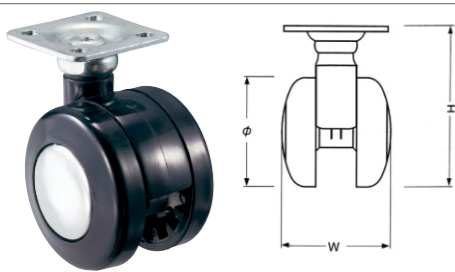

ITEM NO.	W (mm)	H (mm)	Ø (mm)	Weight (g)
FC05-400	46	67	50	120.4

FC05-501

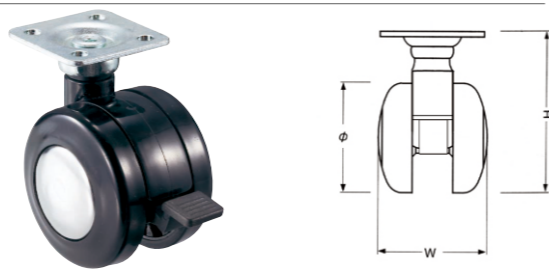

ITEM NO.	W (mm)	H (mm)	Ø (mm)	Weight (g)
FC05-401	46	67	50	121.0

FC06-500

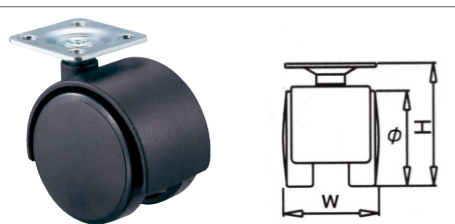

ITEM NO.	W (mm)	H (mm)	Ø (mm)	Weight (g)
FC06-500	45	62	50	80.0

FC06-501



ITEM NO.	W (mm)	H (mm)	Ø (mm)	Weight (g)
FC06-501	45	62	50	90.0

FC07-550

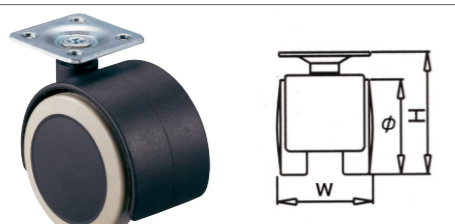

ITEM NO.	W (mm)	H (mm)	Ø (mm)	Weight (g)
FC07-500	68.5	70	55	127.4

FC07-551



ITEM NO.	W (mm)	H (mm)	Ø (mm)	Weight (g)
FC07-501	68.5	70	55	128.0

FC08-750

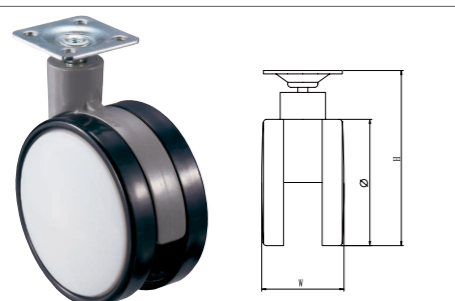

ITEM NO.	W (mm)	H (mm)	Ø (mm)	Weight (g)
FC08-750	48	98	75	145.0

FC08-751

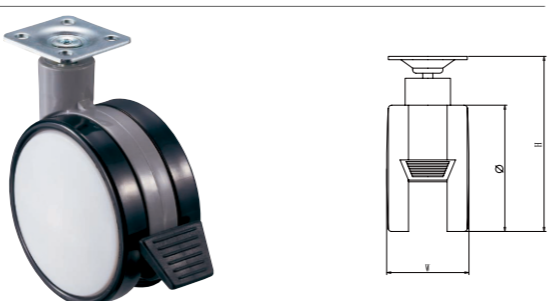

ITEM NO.	W (mm)	H (mm)	Ø (mm)	Weight (g)
FC08-751	48	98	75	145.5

FC09-300

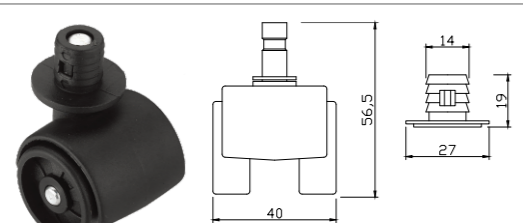

ITEM NO.	W (mm)	H (mm)	Ø (mm)	Weight (g)
FC09-300	40	56.5	30	51

FC10-Base



ITEM NO.	W (mm)	H (mm)	Ø (mm)	Weight (g)
FC10-Base	60	8	60	7



Magnetic Catch

DM001

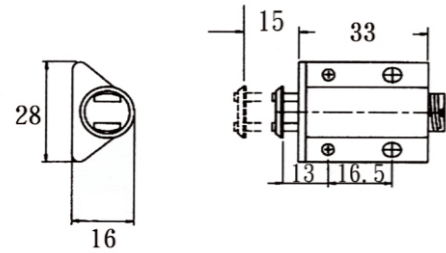

ITEM NO.	Weight (g)	Packing (pcs)
DM001	15.2	1200

DM002

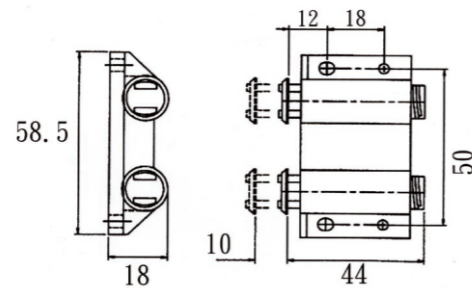

ITEM NO.	Weight (g)	Packing (pcs)
DM002	29.8	600

DM003

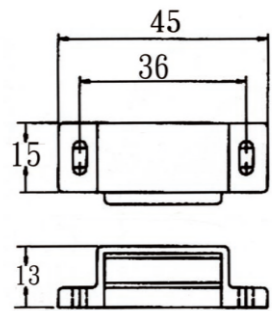

ITEM NO.	Weight (g)	Packing (pcs)
DM003	14.8	1000

DM004

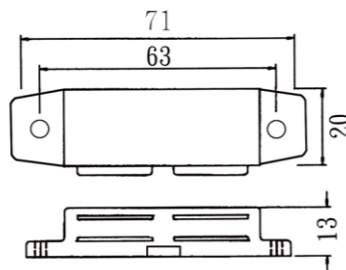

ITEM NO.	Weight (g)	Packing (pcs)
DM004	28.2	500

DM005

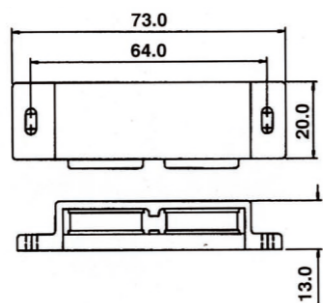

ITEM NO.	Weight (g)	Packing (pcs)
DM005	30	500



Magnetic Catch

DM006

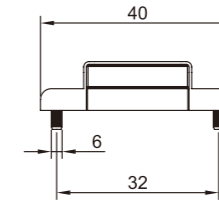

ITEM NO.	Weight (g)	Packing (pcs)
DM006	14.4	1000

DM007

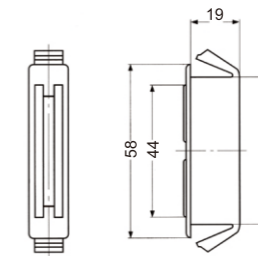
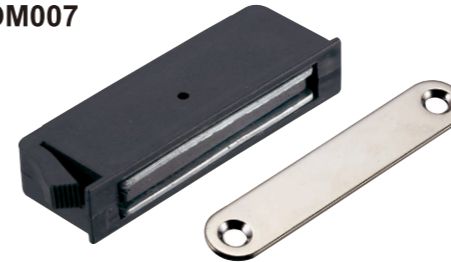

ITEM NO.	Weight (g)	Packing (pcs)
DM007	32.8	1000

DM008

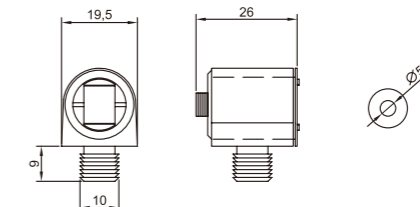

ITEM NO.	Weight (g)	Packing (pcs)
DM008	11.6	200

DM009

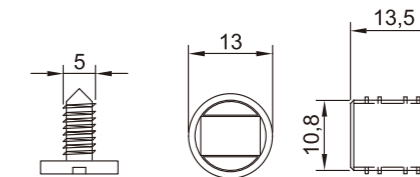

ITEM NO.	Weight (g)	Packing (pcs)
DM009	6.6	1600

DM010

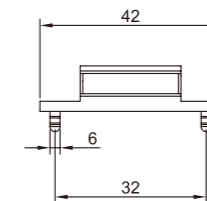

ITEM NO.	Weight (g)	Packing (pcs)
DM010	12.6	500

DM011

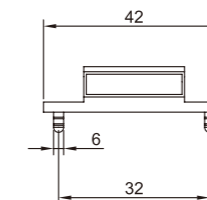
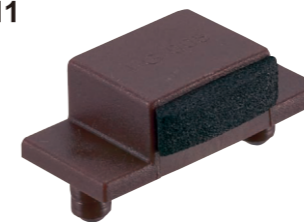

ITEM NO.	Weight (g)	Packing (pcs)
DM011	2.8	1000

DM012

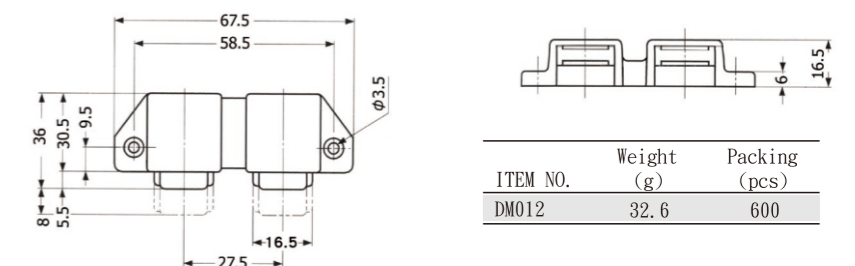

ITEM NO.	Weight (g)	Packing (pcs)
DM012	32.6	600

Magnetic Catch/Roller Catch

Roller Catch

DM013

ITEM NO.	Weight (g)	Packing (pcs)
DM013	15.8	1200

DM014

ITEM NO.	Weight (g)	Packing (pcs)
DM014	31	600

DM015

ITEM NO.	Weight (g)	Packing (pcs)
DM015	15.8	600

Roller Catch

C-01

ITEM NO.	Weight (g)	Packing (pcs)
C-01	3	1000

C-02

ITEM NO.	Weight (g)	Packing (pcs)
C-02	12.6	1000

C-03

ITEM NO.	Weight (g)	Size (mm)	Packing (pcs)
C-03	24	28	1000

C-04-1

ITEM NO.	W (mm)	A (mm)	H (mm)	B (mm)
C-04-1	39	10	10	25
C-04-2	44	10	10	25
C-04-3	49	11	11	28.5
C-04-4	60	13.5	13.5	35
C-04-5	69	16	16	40

C-05-1

ITEM NO.	H (mm)	W (mm)	A (mm)	Weight (g)	Packing (pcs)
C-05-1	10	7.575	9.5	4.4	1000
C-05-2	12	9.09	11	7.4	600
C-05-3	16	12.12	15	16	500
C-05-4	18	15.15	18	18	300

C-06

ITEM NO.	Weight (g)	Packing (pcs)
C-06	11.4	1000

C-07

ITEM NO.	Weight (g)	Packing (pcs)
C-07	10	1000

Other Plastics Fittings

Other Plastics Fittings



Plastic Cup/Plastic Hinge/Other Plastic Parts

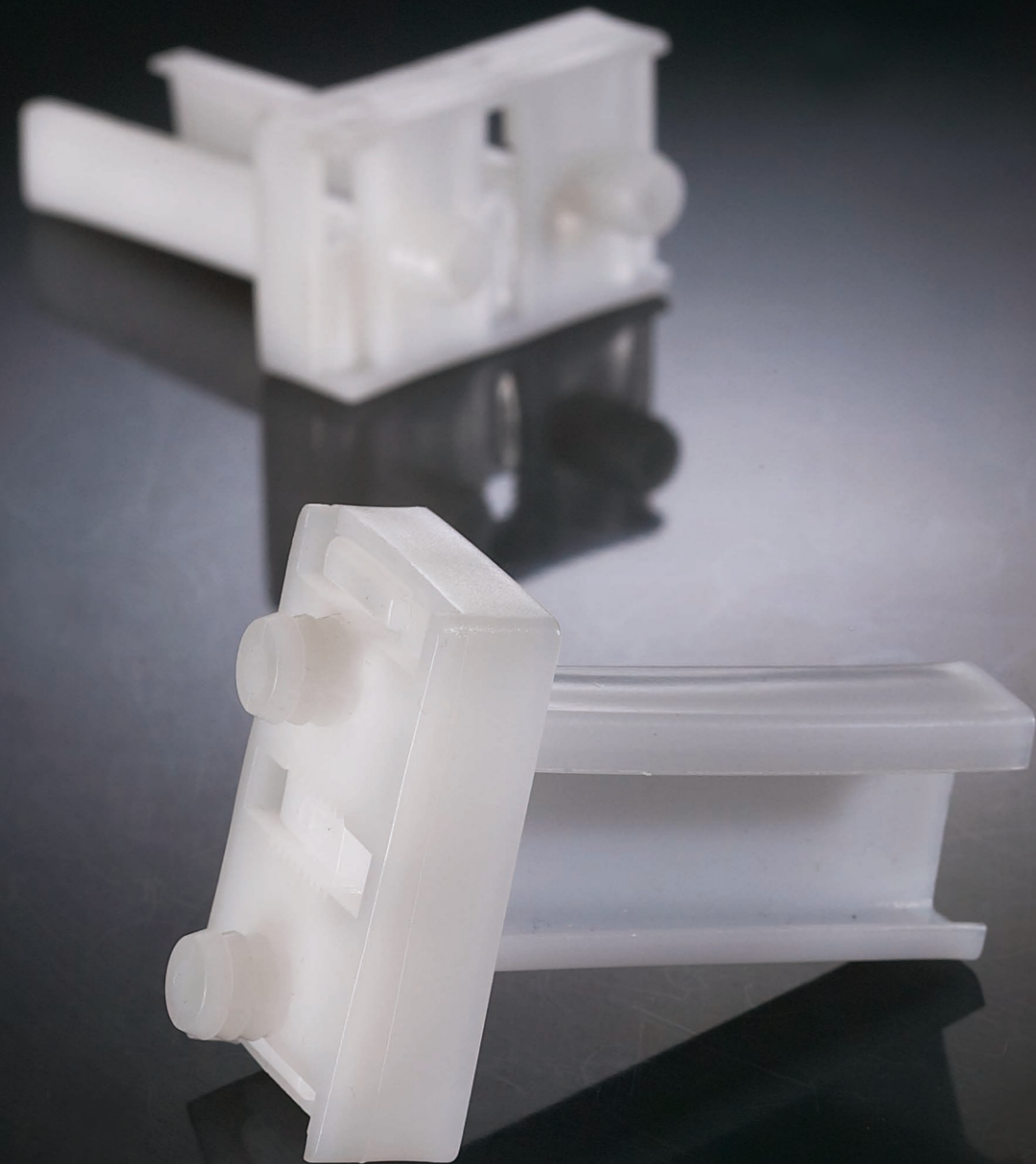

Plastic Cup

PC01-30

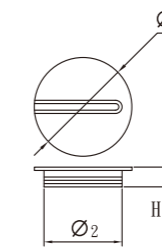

ITEM NO.	Ø1 (mm)	H (mm)	Ø2 (mm)	Weight (g)	Packing (pcs)
PC01-30	33.5	9.5	30	3.4	1000

PC02-43

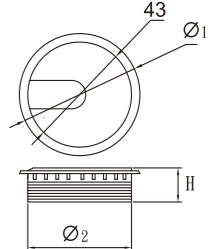

ITEM NO.	Ø1 (mm)	H (mm)	Ø2 (mm)	Weight (g)	Packing (pcs)
PC02-43	51	24	43	11	1000

PC03-50

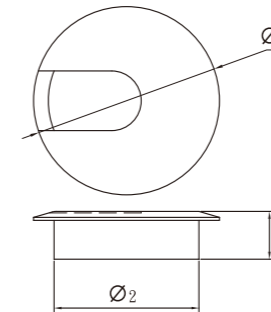

ITEM NO.	Ø1 (mm)	H (mm)	Ø2 (mm)	Weight (g)	Packing (pcs)
PC03-50	63	16	50	11.6	1000

PC04-60

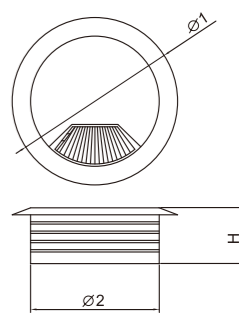

ITEM NO.	Ø1 (mm)	H (mm)	Ø2 (mm)	Weight (g)	Packing (pcs)
PC04-60	72	24	60	20.6	1000

Plastic Hinge

PH01

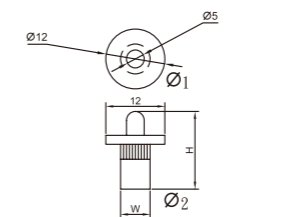

ITEM NO.	Ø1 (mm)	H (mm)	Ø2 (mm)	Weight (g)	Packing (pcs)
PH01	12	24.5	8	1	2500

PH02

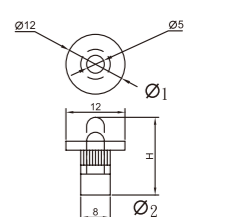

ITEM NO.	Ø1 (mm)	H (mm)	Ø2 (mm)	Weight (g)	Packing (pcs)
PH02	12	24	8	1	2500

Other Plastic Parts

P01

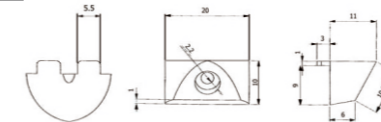

ITEM NO.	Weight (g)	Packing (pcs)
P01	2.0	5000

P02

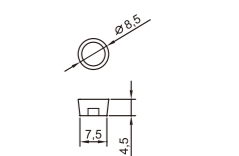

ITEM NO.	Weight (g)	Packing (pcs)
P02	0.1	10000

P03

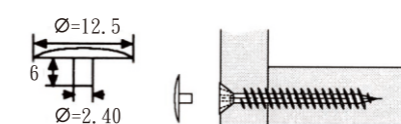
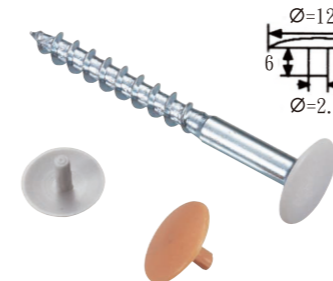

ITEM NO.	Weight (g)	Packing (pcs)
P03	0.1	1000

P04

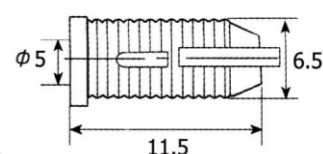
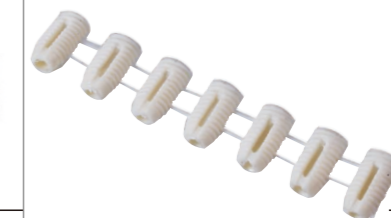

ITEM NO.	Weight (g)	Packing (pcs)
P04	3.2	2500



Other Plastic Parts/Bottom Nail

Board Support Series

Other Plastic Parts

P05

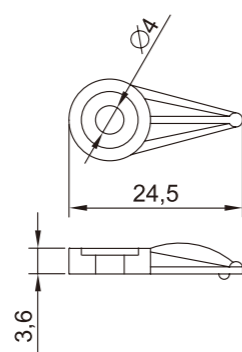

ITEM NO.	Weight (g)	Packing (pcs)
P04	0.6	10000

P06-2

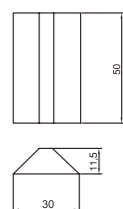

ITEM NO.	Weight (g)	Packing (pcs)
P06-2	3.6	4000

P06-4

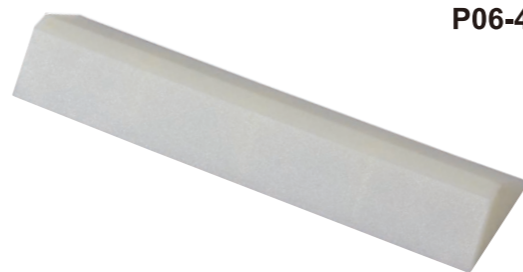

ITEM NO.	Weight (g)	Packing (pcs)
P06-4	5.0	2500

P07-R

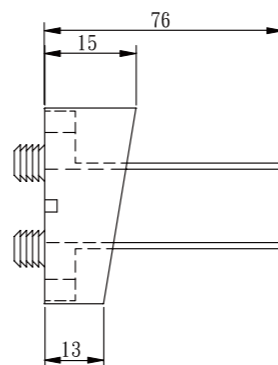
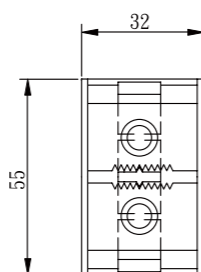
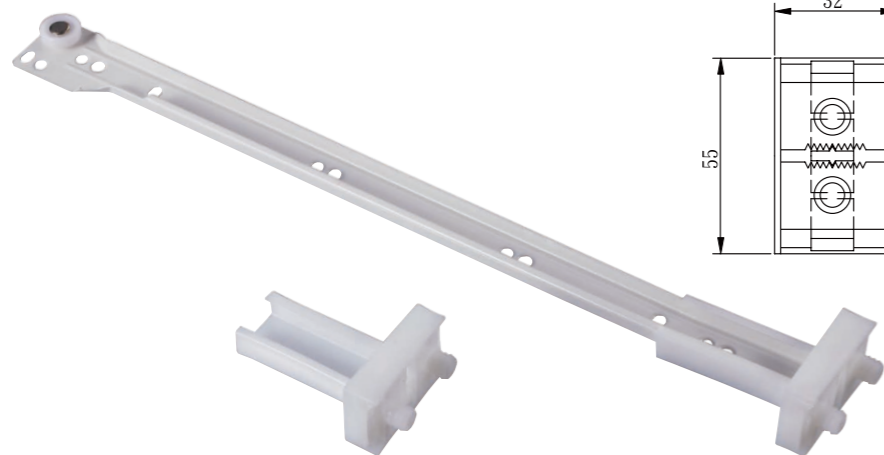

ITEM NO.	Weight (g)	Packing (pcs)
P07-R	22.0	500
P07-L	22.0	500

Bottom Nail

PN-01



PN-02



PN-03

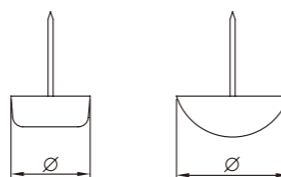

PN-04

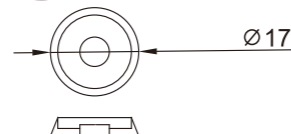

ITEM NO.	Ø(mm)	Weight (g)	Packing (pcs)
PN-01	16	1.6	2000
PN-02	18	2.2	2000
PN-03	21	2.6	2000
PN-04	17	7.6	2000



Board Support Series

SP-01

ITEM NO.	L (mm)	Ø (mm)	Weight (g)	Packing (pcs)
SP-01	27.5	5.0	12.4	1000

SP-02

ITEM NO.	L (mm)	Ø (mm)	Weight (g)	Packing (pcs)
SP-02	15	5.5	3.4	1000

SP-03

ITEM NO.	L (mm)	Ø (mm)	Weight (g)	Packing (pcs)
SP-03	16.3	5.0	2.6	1000

SP-04

ITEM NO.	L (mm)	Ø (mm)	Weight (g)	Packing (pcs)
SP-04	25.5	6.0	6.6	1000

SP-14

ITEM NO.	L (mm)	Ø (mm)	Weight (g)	Packing (pcs)
SP-14	20.5	5	3.8	1000

SP-05

ITEM NO.	L (mm)	Ø (mm)	Weight (g)	Packing (pcs)
SP-05	15.0	9.0	6.4	1000

SP-06

ITEM NO.	L (mm)	Ø (mm)	Weight (g)	Packing (pcs)
SP-06	23.5	6.0	0.8	1000

SP-07

ITEM NO.	L (mm)	Ø (mm)	Weight (g)	Packing (pcs)
SP-07	28.0	6.5	1.6	1000

SP-08

ITEM NO.	L (mm)	Ø (mm)	Weight (g)	Packing (pcs)
SP-08	25.5	3.0	2.0	1000

SP-09

ITEM NO.	L (mm)	Ø (mm)	Weight (g)	Packing (pcs)
SP-09	17.5	5.0	3.6	1000

SP-10

ITEM NO.	L (mm)	Ø (mm)	Weight (g)	Packing (pcs)
SP-10	19.5	6.4	1.2	1000

SP-11

ITEM NO.	L (mm)	Ø (mm)	Weight (g)	Packing (pcs)
SP-11	40.0	6.0	1.4	1000

SP-12

ITEM NO.	L (mm)	Ø (mm)	Weight (g)	Packing (pcs)
SP-12	28.0	6.0	6.8	1000

SP-13

ITEM NO.	L (mm)	Ø (mm)	Weight (g)	Packing (pcs)
SP-13	30.0	5.0	10	1000

Insert-Nut/Tee Nut/Barrel Nut

Insert-Nut

N01

ITEM NO.	H (mm)	D (size)
N01-1	9	5/32
N01-2	10	3/16
N01-3	10	5/32
N01-4	8	1/4
N01-5	10	1/4
N01-6	12	1/4
N01-7	15	1/4
N01-8	18	1/4
N01-9	20	1/4
N01-10	12	5/16
N01-11	14	5/16
N01-12	20	5/16
N01-13	25	5/16
N01-14	18	3/8

N02

ITEM NO.	H (mm)	D (size)
N02-1	8	3/16
N02-2	10	3/16
N02-3	10	5/32
N02-4	10	1/4
N02-5	8	M5
N02-6	10	M5
N02-7	8	M6
N02-8	10	M6

N03

ITEM NO.	H (mm)	D (size)
N03-1	8	5/32
N03-2	10	1/4
N03-3	13	1/4
N03-4	13	3/16
N03-5	15	1/4
N03-6	20	1/4
N03-7	13	5/16
N03-8	20	5/16
N03-9	25	1/4
N03-10	10	M5
N03-11	13	M6
N03-12	20	M6
N03-13	13	M8
N03-14	20	M8

N04

ITEM NO.	H (mm)	D (size)
N04-1	10	M4
N04-2	12	1/4
N04-3	12	M6
N04-4	15	1/4
N04-5	15	M6
N04-6	15	5/16
N04-7	15	3/8
N04-8	20	1/4
N04-9	20	6M

N05

ITEM NO.	H (mm)	D (size)
N05-1	11	M4
N05-2	9	3/16
N05-3	8	1/4
N05-4	10	1/4
N05-5	12	1/4
N05-6	13	1/4
N05-7	15	1/4
N05-8	20	3/16
N05-9	20	1/4
N05-10	20	M6
N05-11	25	1/4
N05-12	25	M6
N05-13	13	5/16
N05-14	13	M8
N05-15	20	5/16
N05-16	20	M8
N05-17	25	5/16
N05-18	25	M8
N05-19	25	3/8
N05-20	25	M10

Tee Nut

NT01

ITEM NO.	W (mm)	H (mm)	D (size)
NT01-1	15	8	1/4
NT01-2	18	10	1/4
NT01-3	22	10	1/4
NT01-4	22	11	5/16
NT01-5	25	12	3/8
NT01-6	15	8	M4
NT01-7	16	8	M5
NT01-8	19	10	M6
NT01-9	22	11	M8
NT01-10	25	12	M10

Barrel Nut

NZ02

ITEM NO.	H (mm)	D (size)
NZ01	13	1/4
NZ02	18	1/4
NZ03	15	1/4
NZ04	16	M6
NZ05	13	M6
NZ06	10	3/16
NZ07	11	1/4
NZ08	18	5/16

NZ04

Hardware for TV & BED

Hardware for TV & BED



Metal bracket



I-01

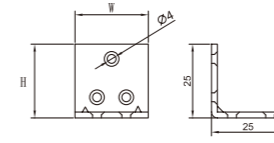

ITEM NO.	W (mm)	H (mm)	Weight (g)
I-01	25	25	16.4

I-02

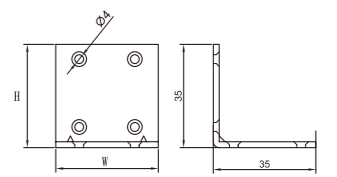

ITEM NO.	W (mm)	H (mm)	Weight (g)
I-02	35	35	32.8

I-03

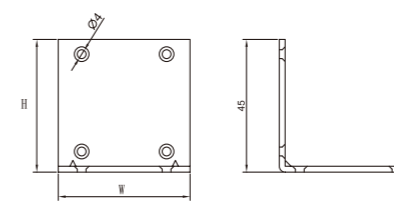
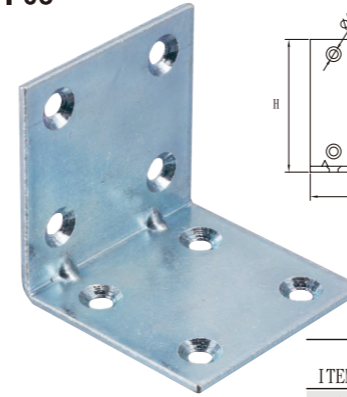

ITEM NO.	W (mm)	H (mm)	Weight (g)
I-03	45	45	57.4

I-04

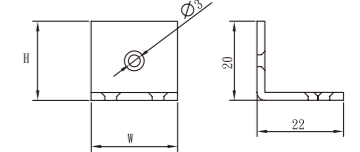
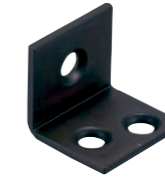

ITEM NO.	W (mm)	H (mm)	Weight (g)
I-04	22	20	11.4

I-05

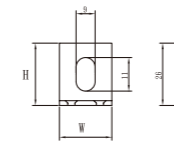

ITEM NO.	W (mm)	H (mm)	Weight (g)
I-05	22	26	12.2

I-06

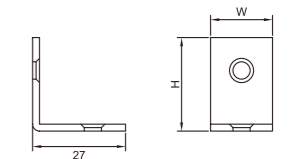

ITEM NO.	W (mm)	H (mm)	Weight (g)
I-06	19	22	13.2

I-07

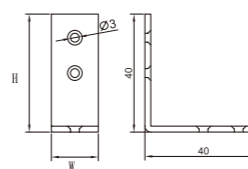

ITEM NO.	W (mm)	H (mm)	Weight (g)
I-07	16	40	17.8

I-08

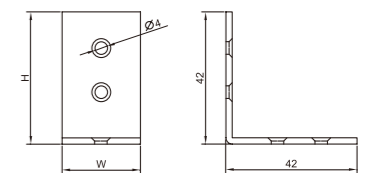
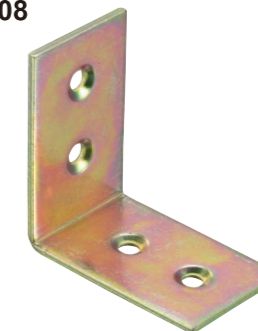

ITEM NO.	W (mm)	H (mm)	Weight (g)
I-08	25	42	30.8

I-09

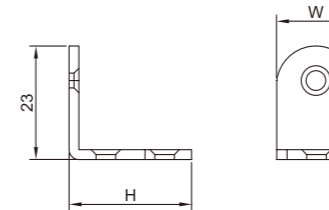
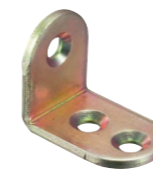

ITEM NO.	W (mm)	H (mm)	Weight (g)
I-09	16	25	9

I-10

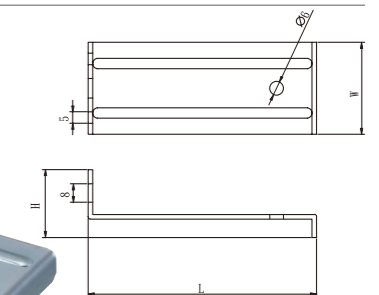
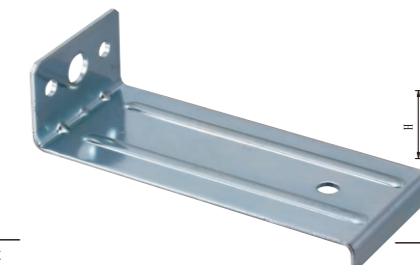

ITEM NO.	W (mm)	H (mm)	L (mm)	Weight (g)
I-10	40	29.5	100	53.1

TV-Swivel/Bed Hinge

TS-01P

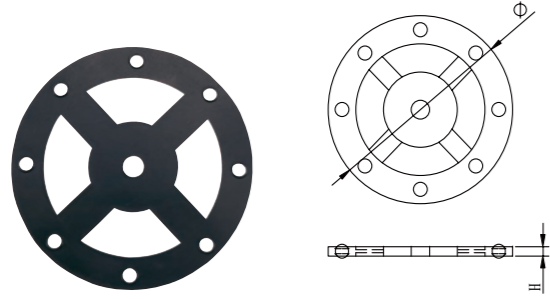

ITEM NO.	H (mm)	Φ (mm)	Weight (g)
TS-01P	2	135	19.0

TS-02P

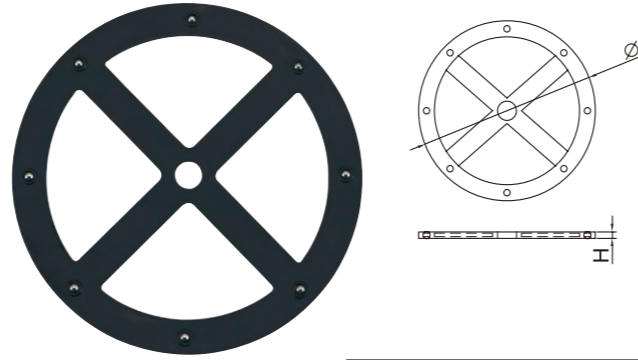

ITEM NO.	H (mm)	Φ (mm)	Weight (g)
TS-02P	2	200	42.8

TS-03

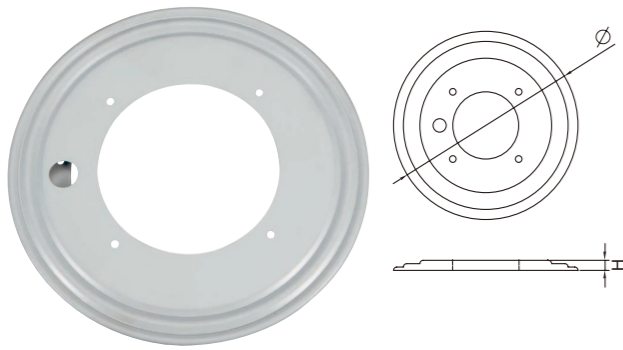

ITEM NO.	H (mm)	Φ (mm)	Weight (g)
TS-03	9	200	386.4

TS-04

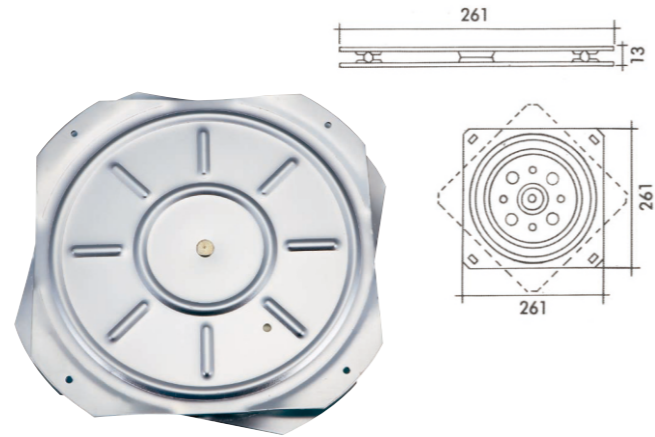

ITEM NO.	H (mm)	Φ (mm)	Weight (g)
TS-04	13	261.0	1635

BH01-3

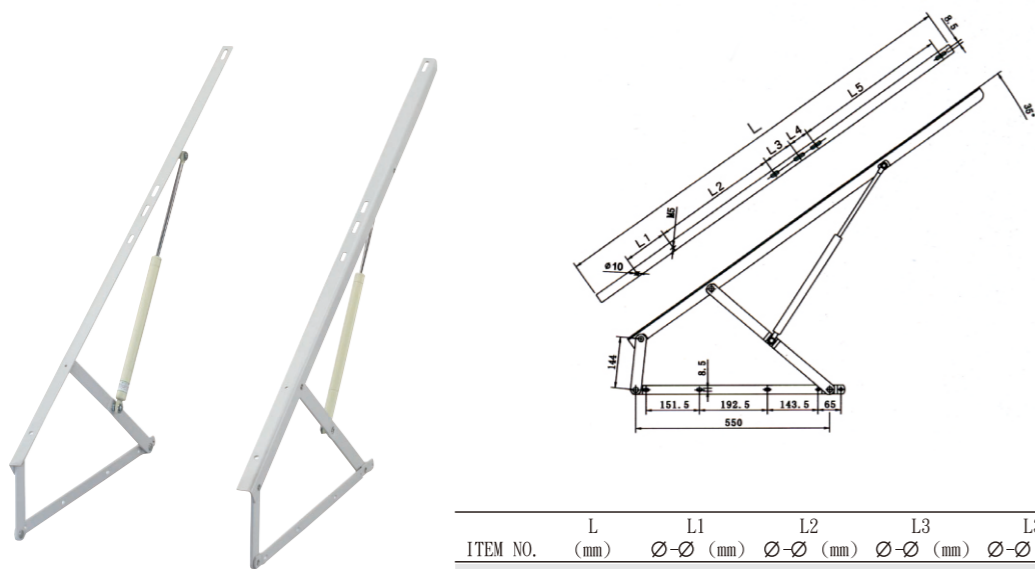

ITEM NO.	L (mm)	L1 (mm)	L2 (mm)	L3 (mm)	L3 (mm)	L3 (mm)	Weight (kg)
BH01-3	3' (915)	175	355	84.5	57.5	136.5	5.8
BH02-4	4" (1220)	170	355	84.5	57.5	136.5	8



Table Cornner

G01

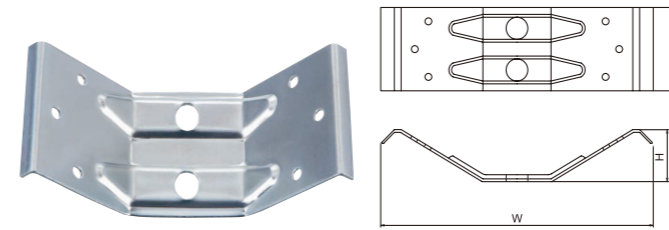

ITEM NO.	W (mm)	H (mm)	D (mm)	Weight (g)
G01	200	37.5	60.0	110

G02

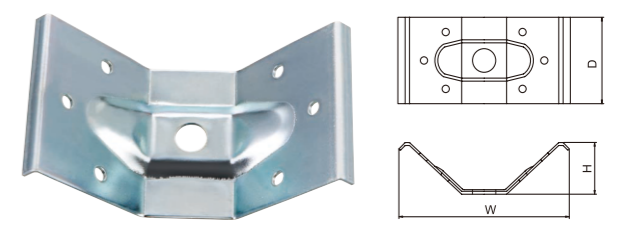

ITEM NO.	W (mm)	H (mm)	D (mm)	Weight (g)
G02	110	35.0	58.5	91

G03

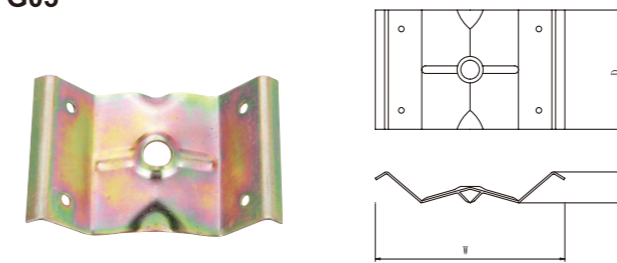

ITEM NO.	W (mm)	H (mm)	D (mm)	Weight (g)
G03	100	16.0	63.0	66

G04

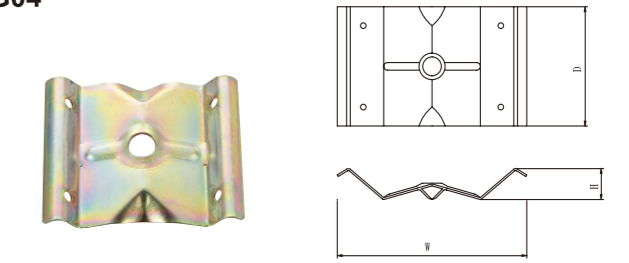

ITEM NO.	W (mm)	H (mm)	D (mm)	Weight (g)
G04	78	9.0	63.0	47

G05

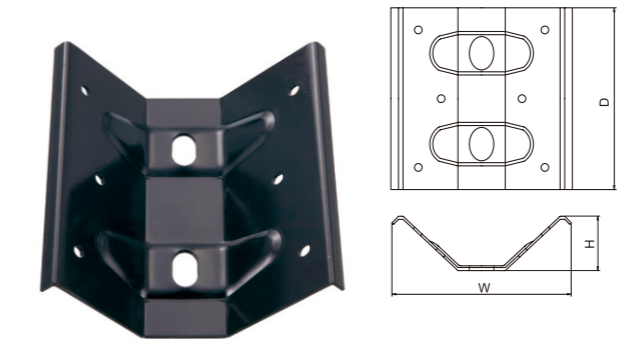

ITEM NO.	W (mm)	H (mm)	D (mm)	Weight (g)
G05	110	35.0	120.0	190

G06

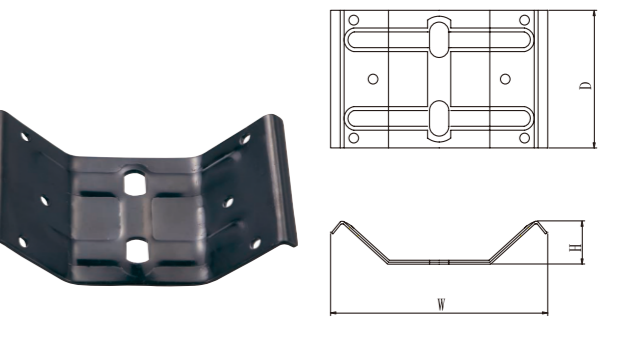

ITEM NO.	W (mm)	H (mm)	D (mm)	Weight (g)
G06	120	29.0	65.5	69

G07-1

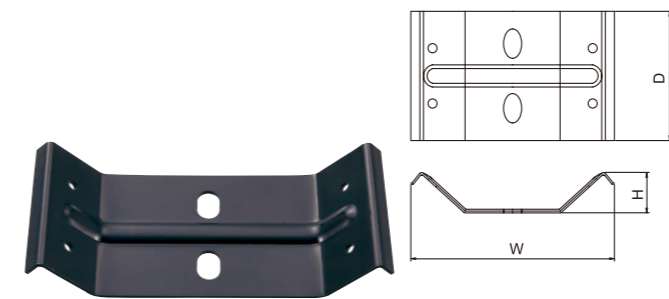

ITEM NO.	W (mm)	H (mm)	D (mm)	Weight (g)
G07	117	21.5	70.0	190
G07-1	158	22.5	70.0	190

G08

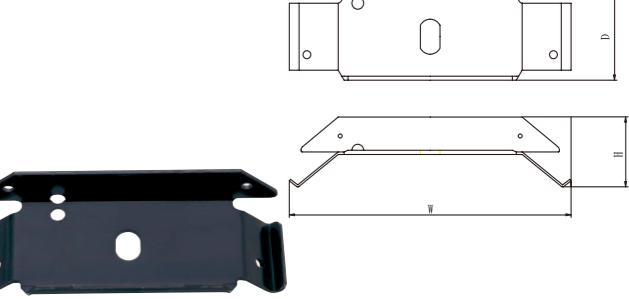

ITEM NO.	W (mm)	H (mm)	D (mm)	Weight (g)
G068	130	35.0	45.5	122

Adjustable Leg & Table Leg



Adjustable Leg

AL01-16

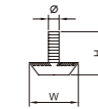

ITEM NO.	H (mm)	W (mm)	Ø (mm)	Weight (g)	Packing (pcs)
AL01-16	29	16	1/4", 5/16", M6	5.4	500

AL01-19

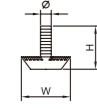

ITEM NO.	H (mm)	W (mm)	Ø (mm)	Weight (g)	Packing (pcs)
AL01-19	31	19	1/4", 5/16", M6	7	500

AL02-23

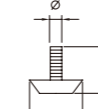

ITEM NO.	H (mm)	W (mm)	Ø (mm)	Weight (g)	Packing (pcs)
AL02-23	30	23	1/4", 5/16"	6.8	500

AL03-25

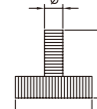

ITEM NO.	H (mm)	W (mm)	Ø (mm)	Weight (g)	Packing (pcs)
AL03-25	32	25	1/4", M6	9.4	250

AL04-25

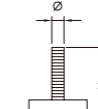

ITEM NO.	H (mm)	W (mm)	Ø (mm)	Weight (g)	Packing (pcs)
AL04-25	34	25	1/4"	11.2	250

AL05-30

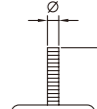

ITEM NO.	H (mm)	W (mm)	Ø (mm)	Weight (g)	Packing (pcs)
AL05-30	31	30	1/4", 5/16", 3/8"	15.8	500

AL06-30

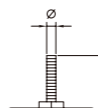
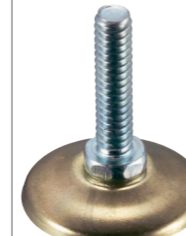

ITEM NO.	H (mm)	W (mm)	Ø (mm)	Weight (g)	Packing (pcs)
AL06-30	37	30	1/4", 5/16"	12.4	500

AL07-38

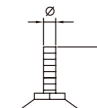

ITEM NO.	H (mm)	W (mm)	Ø (mm)	Weight (g)	Packing (pcs)
AL07-38	43	38	1/4"	23.5	250

AL08-50

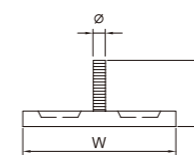

ITEM NO.	H (mm)	W (mm)	Ø (mm)	Weight (g)	Packing (pcs)
AL08-50	30	50	M8	24.6	250

AL09-62

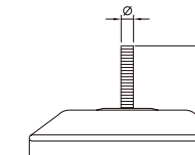

ITEM NO.	H (mm)	W (mm)	Ø (mm)	Weight (g)	Packing (pcs)
AL09-62	42	62	M6	89.2	250

AL10-64

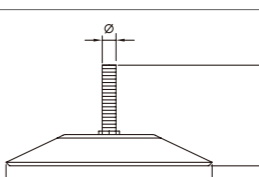

ITEM NO.	H (mm)	W (mm)	Ø (mm)	Weight (g)	Packing (pcs)
AL10-64	42	64	M8	50.8	250

AL11-90

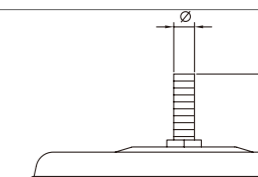

ITEM NO.	H (mm)	W (mm)	Ø (mm)	Weight (g)	Packing (pcs)
AL11-90	54	90	M8	213.2	100

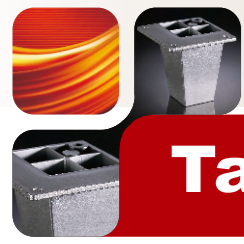
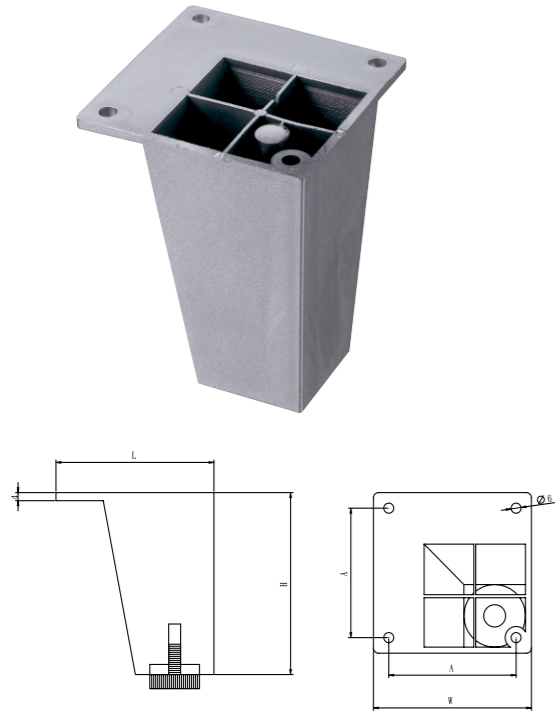

Table Leg

Handle

TL01/02



ITEM NO.	L (mm)	W (mm)	H (mm)	A (mm)	Weight (g)	Packing (pcs)
TL01	63.5	63.5	50	50	64.6	100
TL02	80	80	90	64	104.2	100

TL03

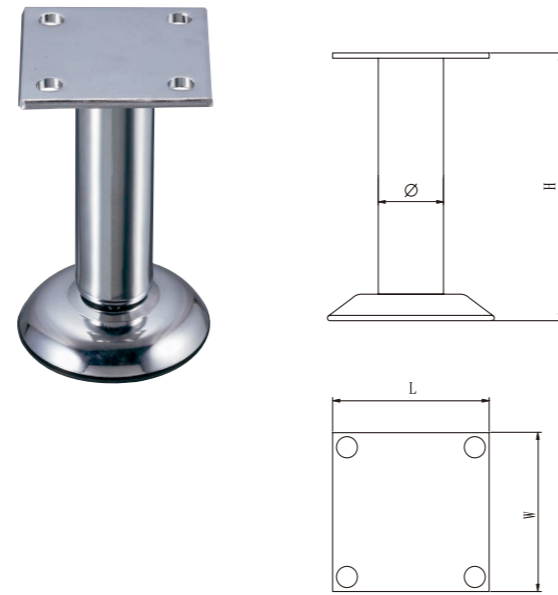

ITEM NO.	L (mm)	W (mm)	H (mm)	Ø (mm)	Weight (g)	Packing (pcs)
TL03	60	60	105	25	399.4	100

TL04-75

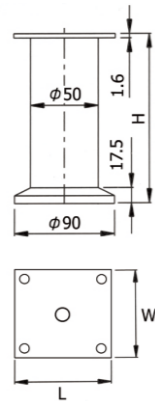

ITEM NO.	L (mm)	W (mm)	H (mm)	Ø (mm)	Weight (g)	Packing (pcs)
TL04	75	75	110	50	219.2	100

TL05

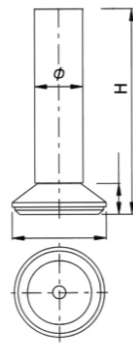

ITEM NO.	L (mm)	W (mm)	H (mm)	Ø (mm)	Weight (g)	Packing (pcs)
TL05	-	-	185	25	172.4	100

TL06

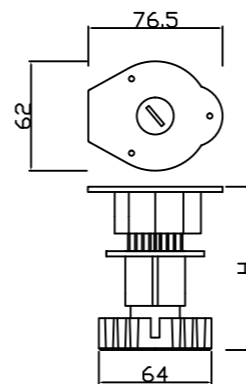

ITEM NO.	L (mm)	W (mm)	H (mm)	Ø (mm)	Weight (g)	Packing (pcs)
TL06	76.5	62	82-125	64	64	200





Handle/Knob

HD01



ITEM NO.	Ø-Ø (mm)	Weight (g)	Packing (pcs)
HD01	76	9.0	100

HD02



ITEM NO.	Ø-Ø (mm)	Weight (g)	Packing (pcs)
HD02	96	36.2	100

HD03



ITEM NO.	Ø-Ø (mm)	Weight (g)	Packing (pcs)
HD03	128	93.6	100

HD04

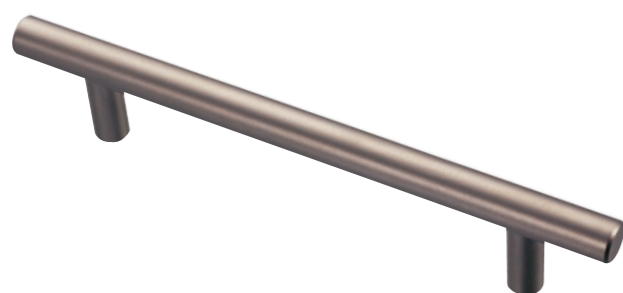

ITEM NO.	Ø-Ø (mm)	Weight (g)	Packing (pcs)
HD04	128	182.4	100

HD05



ITEM NO.	Ø-Ø (mm)	Weight (g)	Packing (pcs)
HD05	128	149.2	100



Handle/Knob

HD06



ITEM NO.	Ø-Ø (mm)	Weight (g)	Packing (pcs)
HD06	128	112.6	100

Knob

HD07



ITEM NO.	Ø-Ø (mm)	Weight (g)	Packing (pcs)
HD07	96	77.6	100

HD08



ITEM NO.	Ø-Ø (mm)	Weight (g)	Packing (pcs)
HD08	-	32.6	200

HD09



ITEM NO.	Ø-Ø (mm)	Weight (g)	Packing (pcs)
HD09	-	25.4	200

HD10



ITEM NO.	Ø-Ø (mm)	Weight (g)	Packing (pcs)
HD10	-	12.4	200

HD11



ITEM NO.	Ø-Ø (mm)	Weight (g)	Packing (pcs)
HD11	-	19.4	200

HD12

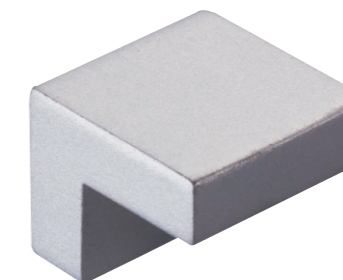

ITEM NO.	Ø-Ø (mm)	Weight (g)	Packing (pcs)
HD12	-	47.4	200



Handle/Knob

HD13



ITEM NO.	Ø-Ø (mm)	Weight (g)	Packing (pcs)
HD13	128	79	100

HD14



ITEM NO.	Ø-Ø (mm)	Weight (g)	Packing (pcs)
HD14	128	52	100

HD15



ITEM NO.	Ø-Ø (mm)	Weight (g)	Packing (pcs)
HD15	96	24.5	100

HD16



ITEM NO.	Ø-Ø (mm)	Weight (g)	Packing (pcs)
HD16	128	88	100

HD17



ITEM NO.	Ø-Ø (mm)	Weight (g)	Packing (pcs)
HD17	128	36	100



Handle/Knob

HD18

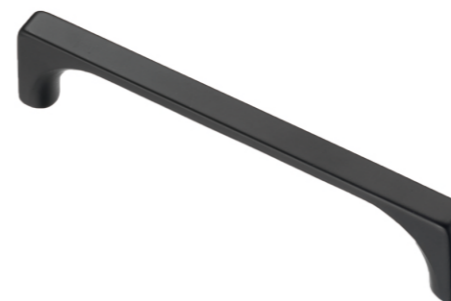

ITEM NO.	Ø-Ø (mm)	Weight (g)	Packing (pcs)
HD18	96	37	100

HD19



ITEM NO.	Ø-Ø (mm)	Weight (g)	Packing (pcs)
HD19	73	37	200

HD20



ITEM NO.	Ø-Ø (mm)	Weight (g)	Packing (pcs)
HD20	76	40	100

HD21



ITEM NO.	Ø-Ø (mm)	Weight (g)	Packing (pcs)
HD21	—	36	100

HD22



ITEM NO.	Ø-Ø (mm)	Weight (g)	Packing (pcs)
HD22	76	77.3	100