

# Sliding Door Fitting

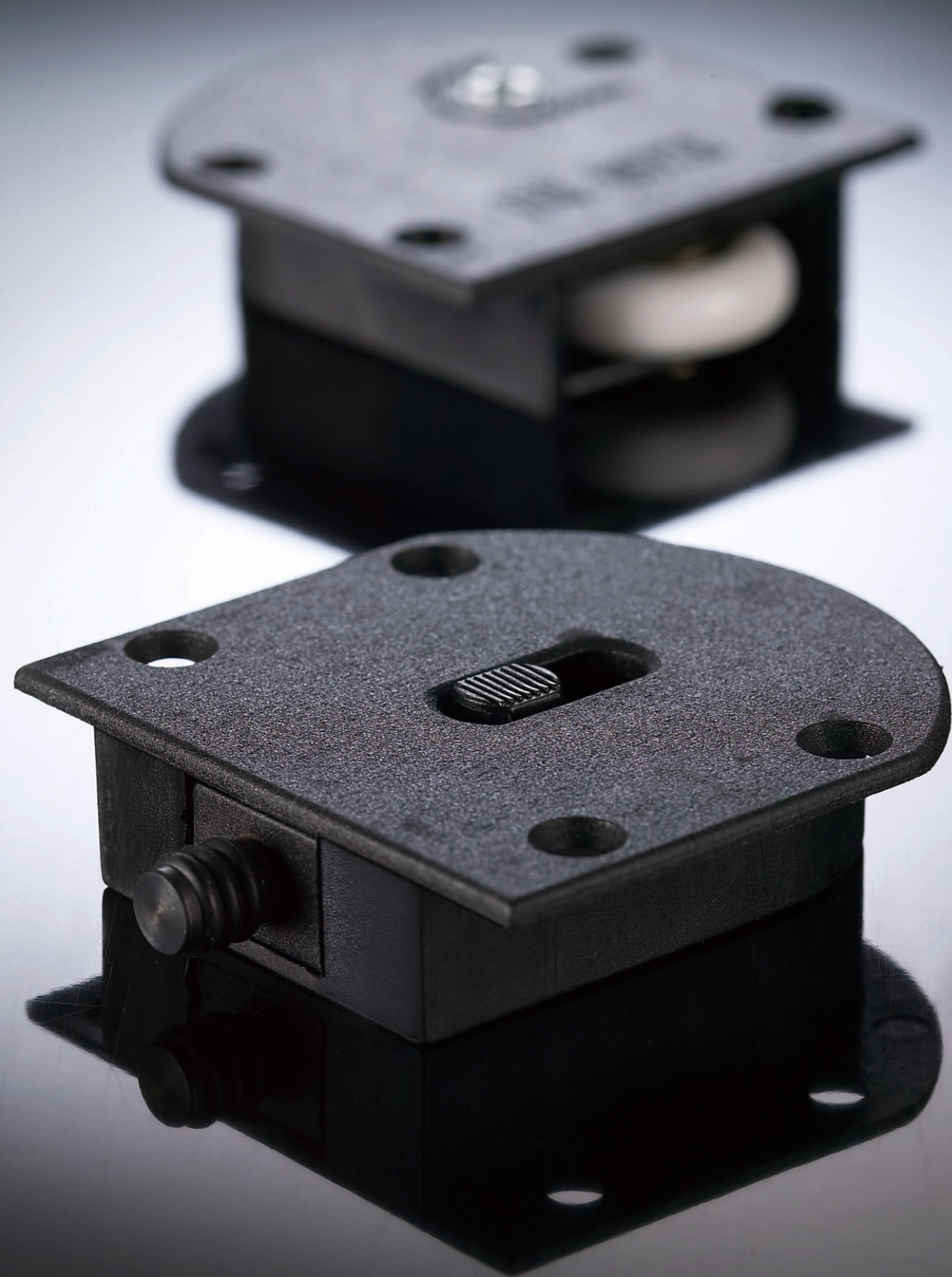

## Top Guide & Lower Roller

W-001



Use screwdriver up and down

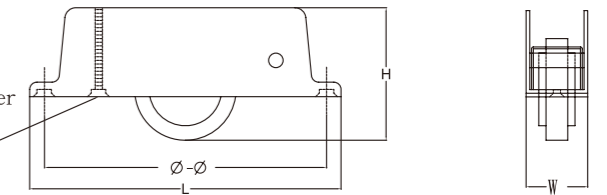

ITEM NO.	L (mm)	W (mm)	H (mm)	Ø-Ø (mm)	Weight (g)	Packing (pcs)
W-001	86	17.0	24.5	76.5	57.8	500

W-002



Use screwdriver up and down

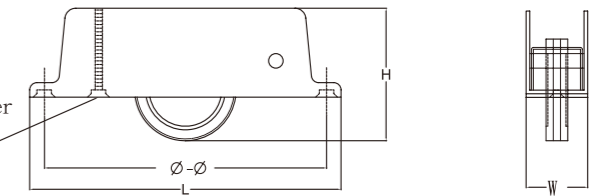

ITEM NO.	L (mm)	W (mm)	H (mm)	Ø-Ø (mm)	Weight (g)	Packing (pcs)
W-002	86	17.0	24.5	76.5	58.0	500

W-003



Use screwdriver up and down

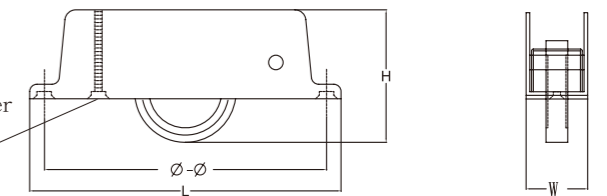

ITEM NO.	L (mm)	W (mm)	H (mm)	Ø-Ø (mm)	Weight (g)	Packing (pcs)
W-003	86	17.0	24.5	76.5	57.6	500

W-004

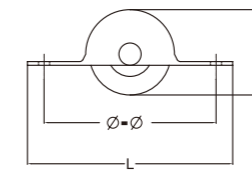

ITEM NO.	L (mm)	W (mm)	H (mm)	Ø-Ø (mm)	Weight (g)	Packing (pcs)
W-004	55	8.5	19.5	46.5	9.4	1000

W-005

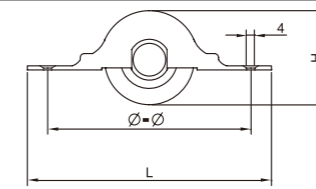

ITEM NO.	L (mm)	W (mm)	H (mm)	Ø-Ø (mm)	Weight (g)	Packing (pcs)
W-005	60	12.5	23.5	50.5	21.4	1000

W-006

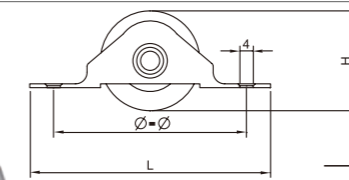

ITEM NO.	L (mm)	W (mm)	H (mm)	Ø-Ø (mm)	Weight (g)	Packing (pcs)
W-006	63	11.5	26.0	51.0	19.4	1000

# Top Guide & Lower Roller/Caster

## Top Guide & Lower Roller

**W-007**

ITEM NO.	L (mm)	W (mm)	H (mm)	Weight (g)	Packing (pcs)
W-007	63	20.0	21.0	27.6	1000

**W-008**

ITEM NO.	L (mm)	W (mm)	H (mm)	Weight (g)	Packing (pcs)
W-008	91	26.0	50.0	98.2	500

**Caster 4101**

ITEM NO.	W (mm)	D (mm)	H (mm)	Ø-Ø (mm)	Weight (g)	Packing (pcs)
4101	53	12.0	53.0	43	45.6	250

**4201**

ITEM NO.	W (mm)	D (mm)	H (mm)	Ø-Ø (mm)	Weight (g)	Packing (pcs)
4201	53	12.0	53.0	43	17.0	250

**4102**

ITEM NO.	L (mm)	W (mm)	H (mm)	Ø-Ø (mm)	Weight (g)	Packing (pcs)
4102	58	14.0	31.5	46	35.6	250

**4202**

ITEM NO.	L (mm)	W (mm)	H (mm)	Ø-Ø (mm)	Weight (g)	Packing (pcs)
4202	58	14.0	31.5	43	11.4	250

# EAF Caster

**FC01-400**

ITEM NO.	W (mm)	H (mm)	Ø (mm)	Weight (g)
FC01-400	40	55	40	69.0

**FC01-401**

ITEM NO.	W (mm)	H (mm)	Ø (mm)	Weight (g)
FC01-401	40	55	40	70.0

**FC02-400**

ITEM NO.	W (mm)	H (mm)	Ø (mm)	Weight (g)
FC02-400	40	70	40	56.0

**FC02-401**

ITEM NO.	W (mm)	H (mm)	Ø (mm)	Weight (g)
FC02-401	40	70	40	62.8

**FC03-400**

ITEM NO.	W (mm)	H (mm)	Ø (mm)	Weight (g)
FC03-400	40	64	40	45.2

**FC03-401**

ITEM NO.	W (mm)	H (mm)	Ø (mm)	Weight (g)
FC03-401	40	64	40	54.2

**FC04-500**

ITEM NO.	W (mm)	H (mm)	Ø (mm)	Weight (g)
FC04-500	46	76	50	164.0

**FC04-501**

ITEM NO.	W (mm)	H (mm)	Ø (mm)	Weight (g)
FC04-501	46	76	50	176.6

# Caster

# Catch

FC05-500

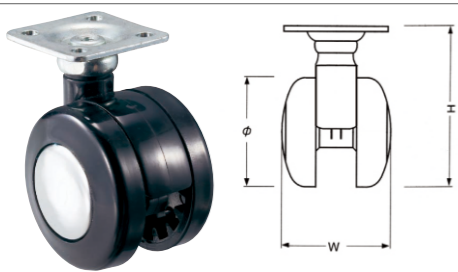

ITEM NO.	W (mm)	H (mm)	Ø (mm)	Weight (g)
FC05-400	46	67	50	120.4

FC05-501

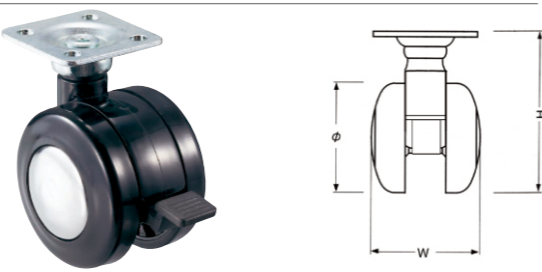

ITEM NO.	W (mm)	H (mm)	Ø (mm)	Weight (g)
FC05-401	46	67	50	121.0

FC06-500

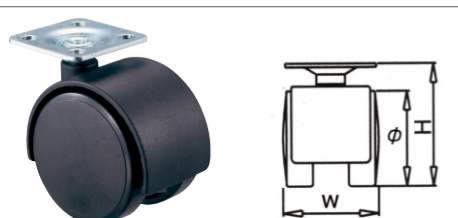

ITEM NO.	W (mm)	H (mm)	Ø (mm)	Weight (g)
FC06-500	45	62	50	80.0

FC06-501



ITEM NO.	W (mm)	H (mm)	Ø (mm)	Weight (g)
FC06-501	45	62	50	90.0

FC07-550

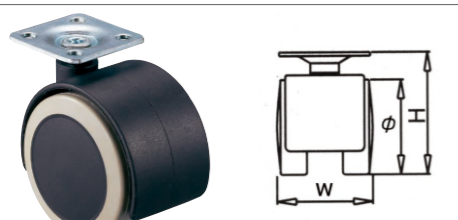

ITEM NO.	W (mm)	H (mm)	Ø (mm)	Weight (g)
FC07-500	68.5	70	55	127.4

FC07-551



ITEM NO.	W (mm)	H (mm)	Ø (mm)	Weight (g)
FC07-501	68.5	70	55	128.0

FC08-750

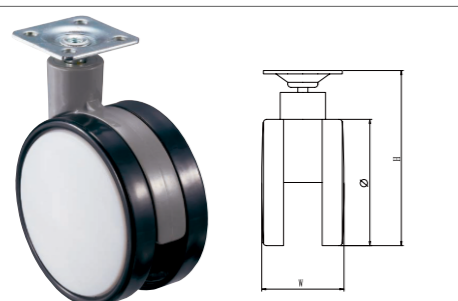

ITEM NO.	W (mm)	H (mm)	Ø (mm)	Weight (g)
FC08-750	48	98	75	145.0

FC08-751

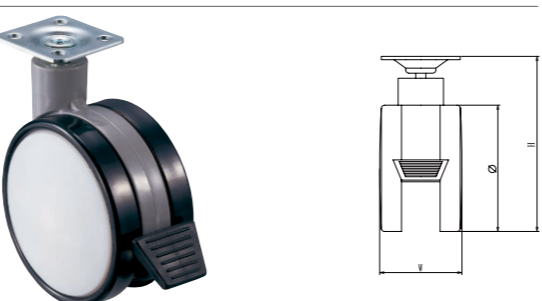

ITEM NO.	W (mm)	H (mm)	Ø (mm)	Weight (g)
FC08-751	48	98	75	145.5

FC09-300

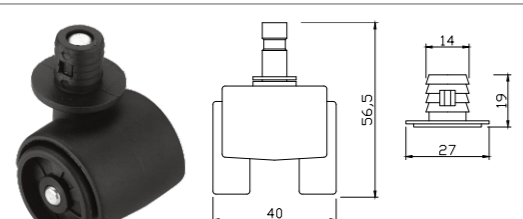

ITEM NO.	W (mm)	H (mm)	Ø (mm)	Weight (g)
FC09-300	40	56.5	30	51

FC10-Base

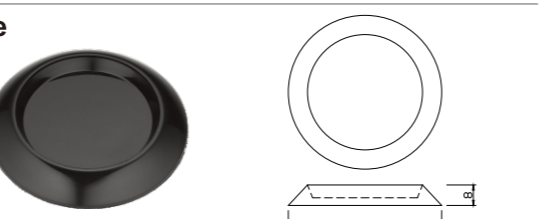

ITEM NO.	W (mm)	H (mm)	Ø (mm)	Weight (g)
FC10-Base	60	8	60	7

